

## PREMIUM LIST



### Silver State Kennel Club

#### **All Breed Dog Shows, Obedience Trials, Rally Trials**

**Saturday: NOHS, Bred by Exhibitor, 2 FSS Open Shows, BPUP 4-6 Months**

**Sunday: NOHS, 2 FSS Open Shows**

**[www.silverstatekennelclub.com](http://www.silverstatekennelclub.com)**

**Saturday March 21, 2026 & Sunday March 22, 2026**

**Friday, March 20, 2026, Specialties**

**Golden Retriever Club of Southern Nevada**

**Great Dane Club of Las Vegas – 2 shows**

**Poodle Club of Las Vegas - 2 shows**

**Vegas Valley Dog Obedience Club – obedience and rally trials**

Above events superintended by [www.jbradshaw.com](http://www.jbradshaw.com)

#### **Southern Nevada Boxer Club**

Cheryl Cazier (602-885-2165) Email: [showsbycheryl@gmail.com](mailto:showsbycheryl@gmail.com) 2926 N. 34th Place, Phoenix, AZ 85018

**Saturday - Concurrent Specialty**

**Great Dane Club of Las Vegas – 1 show**

**Saturday & Sunday – Supported Entry**

**American Belgian Malinois Club**

#### **PRIMM VALLEY RESORT & CASINO**

**31900 S Las Vegas Blvd, Primm, NV 89019**

**Close of entries: Noon Wednesday March 4, 2026**

## IMPORTANT NOTICE

Mail Entries with Fees to Jack Bradshaw

320 Maple Avenue, Torrance, CA 90503

Make checks payable to Jack Bradshaw

FAX: (323) 727-2949 E-MAIL ENTRIES: [www.jbradshaw.com](http://www.jbradshaw.com)

For entries made online there will be a service fee of \$5.00 per dog per show.

There will be a \$4.00 service fee if entries are cancelled for any reason per dog per show.

These service fees are non-refundable.

Include MasterCard, Visa or American Express number & expiration date

There will be a \$5.00 convenience fee charged per dog per show when using a credit card for payment of hand delivered or mailed in entries. Fax machines are available 24 hours a day.

Hand Deliveries - 320 Maple Avenue, Torrance, CA 90503

All entries with fees must be in the office of the Superintendent not later than

## NOON WEDNESDAY, MARCH 4, 2026 PST

### Or by the following limits:

ALL BREED SHOW LIMITED TO 1200 ENTRIES PER DAY

OBEDIENCE & RALLY ENTRIES LIMITED NOT TO EXCEED 8 HOURS PER JUDGE PER DAY.

EACH POODLE SPECIALTY IS LIMITED TO 100 ENTRIES

EACH GREAT DANE SPECIALTY IS LIMITED TO 100 ENTRIES.

after which time no entries may be accepted, cancelled, changed, substituted, corrected, completed, or signed, and no entry fees refunded. Any change or cancellation must be made in writing and received prior to closing, except as provided for in Chapter 11, Section 6 of the American Kennel Club Dog Show Rules. Faxed entries that are received incomplete or are unreadable will not be accepted. The proof of transmission is not proof for verifying faxed entries. PLEASE DO NOT WAIT UNTIL THE LAST MINUTE TO E-MAIL OR FAX YOUR ENTRIES. IF YOU FAX OR E-MAIL ON A CLOSE OF ENTRY DAY, PLEASE SUBMIT PRIOR TO 9:00 AM.

## ENTRY FEES

First Entry* .....	\$36.00
Each Additional Entry of the Same Dog .....	30.00
Bred by .....	25.00
Junior Showmanship .....	FREE
Great Dane Friday # 1 Show Sweepstakes .....	18.00
Great Dane Friday # 1 Show Veteran Parade or Friday # 2 Show Titleholders .....	10.00
Great Dane Friday # 2 Stud Dog or Brood Bitch .....	22.00
Poodle Friday # 1 Show Parade .....	14.00
Poodle Friday Stud Dog, Brood Bitch .....	22.00

## SPECIAL EVENTS

FSS/Open (Saturday and Sunday) .....	36.00
Puppy 4-6 (Saturday) .....	20.00
Pee Wee (Saturday only) .....	FREE

Entries for the Pee Wee Special Attraction will be taken on the day of the show until 10 AM

An AKC Event Fee of \$4.50 is required for each entry in an event. BPUP, Open Shows \$3.00 per entry. There is no Event Fee for Junior Showmanship, Sweepstakes, Brace/Team, Multi-Dog Classes, or Special Attractions.

## Silver State Kennel Club



Member Club of the AKC

**Saturday March 21, 2026 & Sunday March 22, 2026**

**PRIMM VALLEY RESORT & CASINO**

**31900 S Las Vegas Blvd, Primm, NV 89019**

**NO CLASSES FOR BASSET HOUNDS SATURDAY OR SUNDAY  
UNENTERED DOGS ARE NOT ALLOWED ON GROUNDS**

Indoors – Unbenched – Event Hours 7 am – 6 pm

The SSKC show chair, AKC delegate, and President shall not exhibit in SSKC conformation shows

### OFFICERS

President ..... Barbara Alexander  
Vice President ..... Susie Osburn  
Treasurer ..... Toni Young  
Corresponding Secretary ..... Joan Kelly

8358 Wild Thing Ct. Las Vegas, NV 89131

Delegate to the American Kennel Club - Daniele Ledoux-Starzyk

Board of Directors - Pia Valle, David Butterfield

Past President – Virginia (Ginger) Austin

### SHOW COMMITTEE

Virginia (Ginger) Austin – Show Chair

5880 Ponderosa Way Las Vegas, NV 89118 702-275-7590 Cell

Sandy Burns – Obedience and Rally Chair 702-281-9420 Cell

Officers of the Club & Members of the Board of Directors

Trophies ..... David Butterfield  
Grounds ..... Pia Valle  
Vendors ..... Julie Troxel  
Chief Ring Steward ..... Susan Edwards – Stewards Club of Arizona



### CERTIFICATION

Permission has been granted by the American Kennel Club for the holding of this event under American Kennel Club rules and regulations.

Sheila H Goffe, Executive Secretary

## Superintendents

**Jack Bradshaw Dog Show Superintendents/Est. 1898**

**320 Maple Avenue, Torrance, CA 90503**

**Telephone: (323) 727-0136; FAX: (323) 727-2949; Website: [www.jbradshaw.com](http://www.jbradshaw.com)**

**Susan Bradshaw MacLyman / Keith MacLyman**

**Julie Bradshaw Draper / John Bradshaw / Eloise O'Donnell**

**One or more of the above superintendents will attend the show**

## RIBBON PRIZES

The following ribbon prizes will be awarded:

First Prize - **Blue Ribbon**

Third Prize - **Yellow Ribbon**

Second Prize - **Red Ribbon**

Fourth Prize - **White Ribbon**

Winners - **Purple Ribbon**

Reserve Winners - **Purple and White Ribbon**

Best of Winners - **Blue and White Ribbon**

Best of Breed & Best of Variety of Breed - **Purple and Gold Ribbon**

Best of Opposite Sex to Best of Breed or Variety of Breed - **Red and White Ribbon**

Regular/Variety Group - First through Fourth - **Rosette**

Best in Show - **Red, White and Blue Rosette**

Reserve Best in Show - **Red, Silver and Blue Rosette**

Grand Champion Select – **Light Blue and White Ribbon**

Best Junior Handler – **Rose and Green Rosette**

Reserve Best Junior Handler – **Rose and Gray Rosette**

Obedience - High in Trial - **Blue and Gold Rosette**

Obedience - Highest Combined Score - **Blue and Green Rosette**

Obedience - High Scoring Local Dog - **Blue and Silver Rosette**

Rally – Highest Triple Qualifying – **Blue and Red Rosette**

Rally – Highest Combined Score – **Blue and Green Rosette**

Qualifying Score – **Green Ribbon**

Best Bred by Exhibitor (Saturday) – **Dark Green Rosette**

Best 4-6 Month Beginner Puppy in Show (Saturday) – **Pink and Green Rosette**

And the following ribbon prizes for all non-regular classes:

First Prize - **Rose Ribbon**

Third Prize - **Light Green Ribbon**

Second Prize - **Brown Ribbon**

Fourth Prize - **Gray Ribbon**

AKC National Owner – Handled Series Groups

First Prize – **Neon Pink Rosette**

Third Prize – **Teal Rosette**

Second Prize – **Neon Green Rosette**

Fourth Prize – **Cream Rosette**

NOHS Best in Show – **Turquoise Rosette**

NOHS Reserve Best in Show – **Light Green Rosette**

***Silver State KC offers a rosette to dogs finishing their championships, obedience, and rally titles at these shows.***

***Rosettes must be claimed on the day of the show.***

## JUDGES

<b>Mrs. Danelle M. Brown</b>	510 Monarch Trail, Georgetown, TX 78633
<b>Mrs. Marissa L. Clark</b>	3522 115th Ave NW, Gig Harbor, WA 98335
<b>Ms. Denise Dean</b>	P.O. Box 50517, Parks, AZ 86018
<b>Ms. Carol Graham</b>	292201 TWP Rd 262-A, Rocky View, AL T4A 0N2 Canada
<b>Ms. Karen J. Hynek</b>	11801 Links Rd, Mathasville, MO 63357
<b>Mrs. Linn Klingel Brown</b>	5053 E Cedar Creek Dr, Cornville, AZ 86325
<b>Mr. Kenneth Kozak</b>	417 SE 46th St, Oklahoma City, OK 73129
<b>Mr. David J. Peat</b>	10360 E. Raintree Dr, Scottsdale, AZ 85255
<b>Mrs. Sharon Ann Redmer</b>	7687 Nollar Rd, Whitmore Lakes, MI 48189
<b>Ms. Terry Lynn Thornton</b>	175 Cedarcrest Rd, Nogal, NM 88341

\*Judge was Provisional/Permit status for the assignment on the date the panel was approved by AKC.

---

RAMP – The following breeds must be examined on a ramp through all levels of conformation competition: Lagotto Romagnolo, Clumber Spaniel, English Springer Spaniel, Sussex Spaniel, Basset Hound, Cirneco dell'Etna, Kerry Blue Terrier, Bulldog, Chinese Shar-Pei, Chow Chow, Keeshond, Spanish Water Dog.

At the discretion of the judge, the following breeds may be examined on a ramp through all levels of competition: Nova Scotia Duck Tolling Retriever, American Water Spaniel, Boykin Spaniels, Field Spaniel, Welsh Springer Spaniel, Basenji, Grand Basset Griffon Vendeen, Norwegian Elkhound, Whippet, German Pinscher, Portuguese Water Dog, Standard Schnauzer, American Staffordshire Terrier, Irish Terrier, Soft Coated Wheaten Terrier, Staffordshire Bull Terrier, Finnish Spitz, Australian Cattle Dogs, Entlebucher Mountain Dog, Finnish Lapphund, Icelandic Sheepdog, Mudi, Norwegian Buhund, Polish Lowland Sheepdog, Puli, Norrbottenspet.

The following breeds may be examined on the ground, table or ramp: Miniature Bull Terrier.

Junior showmanship judges should follow the above.

Ramps may be used in emergency situations to examine any breed. (In all but emergency situations, the exhibitor has no recourse. In an emergency situation, where use of a ramp is not indicated in the premium list, an exhibitor has the option of withdrawing their entry and receiving a refund.) 1/1/26

---

## SATURDAY

### BEST in SHOW

Ms. Carol Graham

### SPORTING BREEDS

Mrs. Marissa L. Clark

Barbets .....	Ms. Graham
Bracchi Italiani .....	Ms. Graham
Brittanys .....	Ms. Graham
Lagotto Romagnolos .....	Ms. Graham
Nederlandse Kooikerhondjes .....	Ms. Graham
Pointer .....	Ms. Graham
Pointers (German Shorthaired) .....	Ms. Graham
Pointers (German Wirehaired) .....	Ms. Graham
Retrievers (Chesapeake Bay) .....	Ms. Graham
Retrievers (Curly-Coated) .....	Ms. Graham
Retrievers (Flat-Coated) .....	Ms. Graham
Retrievers (Golden) .....	Ms. Graham
Retrievers (Labrador) .....	Ms. Graham
Open, Black; Chocolate; Yellow. Same division of classes in bitches.	
Retrievers (NS Duck Tolling) .....	Ms. Graham
Setters (English) .....	Ms. Graham
Setters (Gordon) .....	Ms. Graham
Setters (Irish) .....	Ms. Graham
Setters (Irish, Red and White) .....	Ms. Graham
Spaniels (American Water) .....	Ms. Graham
Spaniels (Boykin) .....	Ms. Graham
Spaniels (Cumber) .....	Ms. Graham
Spaniels (Cocker) Black .....	Ms. Graham
Spaniels (Cocker) Ascob .....	Ms. Graham
Spaniels (Cocker) Parti Color .....	Ms. Graham
Spaniels (English Cocker) .....	Ms. Graham
Spaniels (English Springer) .....	Ms. Graham
Spaniels (Field) .....	Ms. Graham
Spaniels (Irish Water) .....	Ms. Graham
Spaniels (Sussex) .....	Ms. Graham
Spaniels (Welsh Springer) .....	Ms. Graham
Spinoni Italiani .....	Ms. Graham
Vizslas .....	Ms. Graham
Weimaraners .....	Ms. Graham
Wirehaired Pointing Griffons .....	Ms. Graham
Wirehaired Vizslas .....	Ms. Graham

### HOUND BREEDS

Mr. David J. Peat

Afghan Hounds .....	Mr. Peat
American English Coonhounds .....	Mr. Peat
American Foxhounds .....	Mr. Peat
Azawakh .....	Mr. Peat
Basenjis .....	Mr. Peat
Basset Hounds .....	No Classes
Basset Fauve de Bretagne .....	Mr. Peat
Beagles (Thirteen Inch) .....	Mr. Peat
Beagles (Fifteen Inch) .....	Mr. Peat
Black and Tan Coonhounds .....	Mr. Peat
Bloodhounds .....	Mr. Peat
Bluetick Coonhounds .....	Mr. Peat
Borzoi .....	Mr. Peat
Cirnechi dell Etna .....	Mr. Peat
Dachshunds (Longhaired) .....	Mr. Peat
Open, Miniature 11 lbs. and under at 12 mos. of age and older; Any Eligible Same division of classes in bitches.	
Dachshunds (Smooth) .....	Mr. Peat
Open, Miniature 11 lbs. and under at 12 mos. of age and older; Any Eligible Same division of classes in bitches.	
Dachshunds (Wirehaired) .....	Mr. Peat
Open, Miniature 11 lbs. and under at 12 mos. of age and older; Any Eligible Same division of classes in bitches.	
Foxhounds (English) .....	Mr. Peat
Grand Basset Griffon Vendeens .....	Mr. Peat
Greyhounds .....	Mr. Peat
Harriers .....	Mr. Peat
Ibizan Hounds .....	Mr. Peat
Irish Wolfhounds .....	Mr. Peat

Norwegian Elkhounds .....	Mr. Peat
Otterhounds .....	Mr. Peat
Petits Bassets Griffons Vendeens .....	Mr. Peat
Pharaoh Hounds .....	Mr. Peat
Plott Hounds .....	Mr. Peat
Portuguese Podengo Pequenos .....	Mr. Peat
Redbone Coonhound .....	Mr. Peat
Rhodesian Ridgebacks .....	Mr. Peat
Salukis .....	Mr. Peat
Scottish Deerhounds .....	Mr. Peat
Sloughi .....	Mr. Peat
Treeing Walker Coonhounds .....	Mr. Peat
Whippets .....	Mr. Peat

### WORKING BREEDS

Ms. Karen J. Hynek

Akitas .....	Mrs. Clark
Alaskan Malamutes .....	Mrs. Clark
Anatolian Shepherds .....	Mrs. Clark
Bernese Mountain Dogs .....	Mrs. Clark
Black Russian Terriers .....	Mrs. Clark
Boerboel .....	Mrs. Clark
Boxers .....	Mrs. Clark
Open, Brindle; Fawn. Same division of classes in bitches.	
Bullmastiffs .....	Mrs. Clark
Open, Brindle; Any Other Allowed Color. Same division of classes in bitches.	
Cane Corso .....	Mrs. Clark
Chinook .....	Mrs. Clark
Danish-Swedish Farmdog .....	Mrs. Clark
Doberman Pinschers .....	Mrs. Clark
Open, Black; Any Other Allowed Color. Same division of classes in bitches.	
Dogos Argentino .....	Mrs. Clark
Dogue De Bordeaux .....	Mrs. Clark
German Pinschers .....	Mrs. Clark
Giant Schnauzers .....	Mrs. Clark
Great Danes .....	Ms. Hynek
Open, Black; Blue; Brindle; Fawn; Harlequin; Mantle; Merle. Same division of classes in bitches.	
Great Pyrenees .....	Ms. Hynek
Greater Swiss Mountain Dogs .....	Ms. Hynek
Komondorok .....	Ms. Hynek
Kuvaszok .....	Ms. Hynek
Leonberger .....	Ms. Hynek
Mastiffs .....	Ms. Hynek
Neapolitan Mastiffs .....	Ms. Hynek
Newfoundlands .....	Ms. Hynek
Portuguese Water Dogs .....	Ms. Hynek
Rottweilers .....	Ms. Hynek
S T. Bernards .....	Ms. Hynek
Samoyeds .....	Ms. Hynek
Siberian Huskies .....	Ms. Hynek
Standard Schnauzers .....	Ms. Hynek
Tibetan Mastiffs .....	Ms. Hynek

### TERRIER BREEDS

Ms. Karen J. Hynek

Airedale Terriers .....	Ms. Graham
American Hairless Terriers .....	Ms. Graham
American Staffordshire Terriers .....	Ms. Graham
Australian Terriers .....	Mrs. Redmer
Bedlington Terriers .....	Ms. Graham
Border Terriers .....	Ms. Graham
Bull Terriers (Colored) .....	Ms. Graham
Bull Terriers (White) .....	Ms. Graham
Cairn Terriers .....	Ms. Graham
Cesky Terriers .....	Ms. Graham
Dandie Dinmont Terriers .....	Ms. Graham
Fox Terriers (Smooth) .....	Ms. Graham
Fox Terriers (Wire) .....	Ms. Graham
Glen of Imaal Terriers .....	Ms. Hynek
Irish Terriers .....	Mrs. Redmer
Kerry Blue Terriers .....	Ms. Graham
Lakeland Terriers .....	Mrs. Redmer
Manchester Terriers (Standard) .....	Ms. Dean
Miniature Bull Terriers .....	Ms. Graham
Miniature Schnauzers .....	Ms. Graham

## SATURDAY

Norfolk Terriers .....	Ms. Graham
Norwich Terriers .....	Ms. Graham
Parson Russell Terriers .....	Ms. Graham
Rat Terriers .....	Ms. Graham
Russell Terriers .....	Ms. Graham
Scottish Terriers .....	Ms. Graham
Sealyham Terriers .....	Ms. Hynek
Skye Terriers .....	Ms. Graham
Soft Coated Wheaten Terriers .....	Ms. Graham
Staffordshire Bull Terriers .....	Ms. Graham
Teddy Roosevelt Terriers .....	Ms. Graham
Welsh Terriers .....	Ms. Graham
West Highland White Terriers .....	Ms. Graham

## TOY BREEDS

Ms. Denise Dean

Affenpinschers .....	Ms. Dean
Biewer Terrier .....	Ms. Dean
Brussels Griffons .....	Ms. Dean
Cavalier King Charles Spaniels .....	Ms. Dean
Open, Black & Tan; Blenheim; Ruby; Tri-Color.	
Same division of classes in bitches.	
Chihuahuas (Long Coat) .....	Ms. Dean
Chihuahuas (Smooth Coat) .....	Ms. Dean
Chinese Crested .....	Ms. Dean
Open, Hairless; Powderpuff. Same division of	
classes in bitches.	
English Toy Spaniel	
(Blenheim & Prince Charles) .....	Ms. Dean
English Toy Spaniel	
(King Charles & Ruby) .....	Ms. Dean
Havanese .....	Ms. Dean
Italian Greyhounds .....	Ms. Dean
Japanese Chin .....	Ms. Dean
Maltese .....	Ms. Dean
Manchester Terriers (Toy) .....	Ms. Dean
Miniature Pinschers .....	Ms. Dean
Papillons .....	Ms. Dean
Pekingese .....	Ms. Dean
Pomeranian .....	Ms. Dean
Open, Red, Orange, Cream and Sable; Black,	
Brown and Blue; Any Other Allowed Color.	
Same division of classes in bitches.	
Poodle (Toy) .....	Mrs. Redmer
Pugs .....	Ms. Dean
Open, Black; Fawn. Same division of classes in	
bitches.	
Russian Toy .....	Ms. Dean
Russian Tsvetnaya Bolonka .....	Ms. Dean
Shih Tzu .....	Ms. Dean
Silky Terriers .....	Ms. Dean
Toy Fox Terriers .....	Ms. Dean
Yorkshire Terriers .....	Ms. Dean

## NON-SPORTING BREEDS

Mrs. Sharon Ann Redmer

American Eskimos .....	Mrs. Redmer
Bichons Frises .....	Mrs. Redmer
Boston Terriers .....	Mrs. Redmer
Open, under 15 lbs.; 15 lbs and over Same	
division of classes in bitches.	
Bulldogs .....	Mrs. Redmer
Chinese Shar-Pei .....	Mrs. Redmer
Chow Chows .....	Mrs. Redmer
Open, Black; Red; Any Other Allowed Color.	
Same division of classes in bitches.	
Coton de Tulear .....	Mrs. Redmer
Dalmatians .....	Mrs. Redmer
Open, Black Spotted; Liver-Spotted. Same divi-	
sion of classes in bitches.	
Finnish Spitz .....	Mrs. Redmer
French Bulldogs .....	Mrs. Redmer
Keeshonden .....	Mrs. Redmer
Lhasa Apsos .....	Mrs. Redmer
Lowchen .....	Mrs. Redmer
Norwegian Lundehunds .....	Mrs. Redmer
Poodles (Miniature) .....	Mrs. Redmer
Poodles (Standard) .....	Mrs. Redmer
Schipperkes .....	Mrs. Redmer

Shiba-Inu .....	Mrs. Redmer
Tibetan Spaniels .....	Mrs. Redmer
Tibetan Terriers .....	Mrs. Redmer
Xoloitzcuintli .....	Mrs. Redmer

## HERDING BREEDS

Mrs. Danelle M. Brown

Australian Cattle Dogs .....	Mrs. Brown
Australian Shepherds .....	Mrs. Brown
Open, Black; Blue Merle; Red Merle; Red.	
Same division of classes in bitches.	
Bearded Collies .....	Mrs. Brown
Beauceron .....	Mrs. Brown
Belgian Laekenois .....	Mrs. Brown
Belgian Malinois .....	Mrs. Brown
Belgian Sheepdogs .....	Mrs. Brown
Belgian Tervuren .....	Mrs. Brown
Bergamasco Sheepdogs .....	Mrs. Brown
Berger Picard .....	Mrs. Brown
Border Collies .....	Mrs. Brown
Bouvier Des Flandres .....	Mrs. Brown
Briards .....	Mrs. Brown
Canaan Dog .....	Mrs. Brown
Cardigan Welsh Corgis .....	Mrs. Brown
Collies (Rough) .....	Mrs. Brown
Open, Blue; Sable & White; TriColor; White	
Same division of classes in bitches.	
Collies (Smooth) .....	Mrs. Brown
Entlebucher Mountain Dogs .....	Mrs. Brown
Finnish Lapphund .....	Mrs. Brown
German Shepherd Dogs .....	Mrs. Brown
Icelandic Sheepdogs .....	Mrs. Brown
Lancashire Heelers .....	Mrs. Brown
Miniature American Shepherd .....	Mrs. Brown
Open, Black; Blue Merle; Red Merle; Red.	
Same division of classes in bitches.	
Mudi .....	Mrs. Brown
Norwegian Buhunds .....	Mrs. Brown
Old English Sheepdogs .....	Mrs. Brown
Pembroke Welsh Corgis .....	Mrs. Brown
Polish Lowland Sheepdogs .....	Mrs. Brown
Pulik .....	Mrs. Brown
Pumik .....	Mrs. Brown
Pyrenean Shepherds .....	Mrs. Brown
Shetland Sheepdogs .....	Mrs. Brown
Open, Sable and White; Any Other Allowed	
Color. Same division of classes in bitches.	
Spanish Water Dog .....	Mrs. Brown
Swedish Vallhunds .....	Mrs. Brown

## JUNIOR SHOWMANSHIP COMPETITION

Mr. David J. Peat

## OBEDIENCE

Beginner Novice A .....	Ms. Thornton
Beginner Novice B .....	Ms. Thornton
Novice Class A .....	Ms. Thornton
Novice Class B .....	Ms. Thornton
Novice, Graduate .....	Mr. Kozak
Novice, Preferred .....	Ms. Thornton
Open Class A .....	Mr. Kozak
Open Class B .....	Mr. Kozak
Open, Graduate .....	Mr. Kozak
Open, Preferred .....	Mr. Kozak
Utility Class A .....	Mr. Kozak
Utility Class B .....	Mr. Kozak
Utility, Preferred .....	Mr. Kozak
Versatility Class .....	Mr. Kozak
Rally Novice A .....	Ms. Thornton
Rally Novice B .....	Ms. Thornton
Rally Intermediate .....	Ms. Thornton
Rally Advanced A .....	Ms. Thornton
Rally Advanced B .....	Ms. Thornton
Rally Excellent A .....	Ms. Thornton
Rally Excellent B .....	Ms. Thornton
Rally Master .....	Ms. Thornton
Rally Choice .....	Ms. Thornton

## SUNDAY

### BEST in SHOW

Mrs. Sharon Ann Redmer

### SPORTING BREEDS

Mr. David J. Peat

Barbets .....	Ms. Hynek
Bracchi Italiani .....	Ms. Hynek
Brittanys .....	Ms. Hynek
Lagotto Romagnolos .....	Ms. Hynek
Nederlandse Kooikerhondjes .....	Ms. Hynek
Pointer .....	Ms. Hynek
Pointers (German Shorthaired) .....	Ms. Hynek
Pointers (German Wirehaired) .....	Ms. Hynek
Retrievers (Chesapeake Bay) .....	Ms. Hynek
Retrievers (Curly-Coated) .....	Ms. Hynek
Retrievers (Flat-Coated) .....	Ms. Hynek
Retrievers (Golden) .....	Ms. Hynek
Retrievers (Labrador) .....	Ms. Hynek
Open, Black; Chocolate; Yellow. Same division of classes in bitches.	
Retrievers (NS Duck Tolling) .....	Ms. Hynek
Setters (English) .....	Ms. Hynek
Setters (Gordon) .....	Ms. Hynek
Setters (Irish) .....	Ms. Hynek
Setters (Irish, Red and White) .....	Ms. Hynek
Spaniels (American Water) .....	Ms. Hynek
Spaniels (Boykin) .....	Ms. Hynek
Spaniels (Clumber) .....	Ms. Hynek
Spaniels (Cocker) Black .....	Ms. Hynek
Spaniels (Cocker) Ascob .....	Ms. Hynek
Spaniels (Cocker) Parti Color .....	Ms. Hynek
Spaniels (English Cocker) .....	Ms. Hynek
Spaniels (English Springer) .....	Ms. Hynek
Spaniels (Field) .....	Ms. Hynek
Spaniels (Irish Water) .....	Ms. Hynek
Spaniels (Sussex) .....	Ms. Hynek
Spaniels (Welsh Springer) .....	Ms. Hynek
Spinoni Italiani .....	Ms. Hynek
Weimaraners .....	Ms. Hynek
Wirehaired Pointing Griffons .....	Ms. Hynek
Wirehaired Vizslas .....	Ms. Hynek

### HOUD BREEDS

Ms. Carol Graham

Afghan Hounds .....	Ms. Graham
American English Coonhounds .....	Ms. Graham
American Foxhounds .....	Ms. Graham
Azawakh .....	Ms. Graham
Basenjis .....	Ms. Graham
Basset Hounds .....	No Classes
Basset Fauve de Bretagne .....	Ms. Graham
Beagles (Thirteen Inch) .....	Ms. Graham
Beagles (Fifteen Inch) .....	Ms. Graham
Black and Tan Coonhounds .....	Ms. Graham
Bloodhounds .....	Ms. Graham
Bluetick Coonhounds .....	Ms. Graham
Borzoi .....	Ms. Graham
Cirnechi dell Etna .....	Ms. Graham
Dachshunds (Longhaired) .....	Ms. Graham
Open, Miniature 11 lbs. and under at 12 mos. of age and older; Any Eligible Same division of classes in bitches.	
Dachshunds (Smooth) .....	Ms. Graham
Open, Miniature 11 lbs. and under at 12 mos. of age and older; Any Eligible Same division of classes in bitches.	
Dachshunds (Wirehaired) .....	Ms. Graham
Open, Miniature 11 lbs. and under at 12 mos. of age and older; Any Eligible Same division of classes in bitches.	
Foxhounds (English) .....	Ms. Graham
Grand Basset Griffon Vendeens .....	Ms. Graham
Greyhounds .....	Ms. Graham
Harriers .....	Ms. Graham
Ibizan Hounds .....	Ms. Graham
Irish Wolfhounds .....	Ms. Graham
Norwegian Elkhounds .....	Ms. Graham

Otterhounds .....	Ms. Graham
Petits Bassets Griffons Vendeens .....	Ms. Graham
Pharaoh Hounds .....	Ms. Graham
Plott Hounds .....	Ms. Graham
Portuguese Podengo Pequenos .....	Ms. Graham
Redbone Coonhound .....	Ms. Graham
Rhodesian Ridgebacks .....	Ms. Graham
Salukis .....	Ms. Graham
Scottish Deerhounds .....	Ms. Graham
Sloughi .....	Ms. Graham
Treeing Walker Coonhounds .....	Ms. Graham
Whippets .....	Ms. Graham

### WORKING BREEDS

Ms. Denise Dean

Akitas .....	Ms. Dean
Alaskan Malamutes .....	Ms. Dean
Anatolian Shepherds .....	Ms. Dean
Bernese Mountain Dogs .....	Ms. Dean
Black Russian Terriers .....	Ms. Dean
Boerboel .....	Ms. Dean
Boxers .....	Ms. Dean
Open, Brindle; Fawn. Same division of classes in bitches.	
Bullmastiffs .....	Ms. Dean
Open, Brindle; Any Other Allowed Color. Same division of classes in bitches.	
Cane Corso .....	Ms. Dean
Chinook .....	Ms. Dean
Danish-Swedish Farmdog .....	Ms. Dean
Doberman Pinschers .....	Ms. Dean
Open, Black; Any Other Allowed Color. Same division of classes in bitches.	
Dogos Argentino .....	Ms. Dean
Dogue De Bordeaux .....	Ms. Dean
German Pinschers .....	Ms. Dean
Giant Schnauzers .....	Ms. Dean
Great Danes .....	Ms. Dean
Open, Black; Blue; Brindle; Fawn; Harlequin; Mantle; Merle. Same division of classes in bitches.	
Great Pyrenees .....	Mr. Peat
Greater Swiss Mountain Dogs .....	Mr. Peat
Komondorok .....	Mr. Peat
Kuvaszok .....	Mr. Peat
Leonberger .....	Mr. Peat
Mastiffs .....	Mr. Peat
Neapolitan Mastiffs .....	Mr. Peat
Newfoundlands .....	Mr. Peat
Portuguese Water Dogs .....	Mr. Peat
Rottweilers .....	Mr. Peat
S T. Bernards .....	Mr. Peat
Samoyeds .....	Mr. Peat
Siberian Huskies .....	Mr. Peat
Standard Schnauzers .....	Mr. Peat
Tibetan Mastiffs .....	Mr. Peat

### TERRIER BREEDS

Ms. Carol Graham

Airedale Terriers .....	Ms. Hynek
American Hairless Terriers .....	Ms. Hynek
American Staffordshire Terriers .....	Ms. Hynek
Australian Terriers .....	Ms. Hynek
Bedlington Terriers .....	Ms. Hynek
Border Terriers .....	Ms. Hynek
Bull Terriers (Colored) .....	Ms. Hynek
Bull Terriers (White) .....	Ms. Hynek
Cairn Terriers .....	Ms. Hynek
Cesky Terriers .....	Mrs. Klingel Brown
Dandie Dinmont Terriers .....	Ms. Hynek
Fox Terriers (Smooth) .....	Ms. Hynek
Fox Terriers (Wire) .....	Ms. Hynek
Glen of Imaal Terriers .....	Mrs. Brown
Irish Terriers .....	Ms. Hynek
Kerry Blue Terriers .....	Ms. Hynek
Lakeland Terriers .....	Ms. Hynek
Manchester Terriers (Standard) .....	Ms. Hynek
Miniature Bull Terriers .....	Ms. Hynek
Miniature Schnauzers .....	Ms. Hynek



## SUNDAY

Norfolk Terriers .....	Ms. Hynek
Norwich Terriers .....	Ms. Hynek
Parson Russell Terriers .....	Ms. Hynek
Rat Terriers .....	Ms. Hynek
Russell Terriers .....	Ms. Hynek
Scottish Terriers .....	Ms. Hynek
Sealyham Terriers .....	Mrs. Brown
Skye Terriers .....	Ms. Hynek
Soft Coated Wheaten Terriers .....	Ms. Hynek
Staffordshire Bull Terriers .....	Ms. Hynek
Teddy Roosevelt Terriers .....	Ms. Hynek
Welsh Terriers .....	Ms. Hynek
West Highland White Terriers .....	Ms. Hynek

## TOY BREEDS

Mrs. Marissa L. Clark

Affenpinschers .....	Mrs. Clark
Biewer Terrier .....	Mrs. Clark
Brussels Griffons .....	Mrs. Clark
Cavalier King Charles Spaniels .....	Mrs. Clark
Open, Black & Tan; Blenheim; Ruby; Tri-Color.	
Same division of classes in bitches.	
Chihuahuas (Long Coat) .....	Mrs. Clark
Chihuahuas (Smooth Coat) .....	Mrs. Clark
Chinese Crested .....	Mrs. Clark
Open, Hairless; Powderpuff. Same division of	
classes in bitches.	
English Toy Spaniel	
(Blenheim & Prince Charles) .....	Mrs. Clark
English Toy Spaniel	
(King Charles & Ruby) .....	Mrs. Clark
Havanese .....	Mrs. Clark
Italian Greyhounds .....	Mrs. Clark
Japanese Chin .....	Mrs. Clark
Maltese .....	Mrs. Clark
Manchester Terriers (Toy) .....	Mrs. Clark
Miniature Pinschers .....	Mrs. Clark
Papillons .....	Mrs. Clark
Pekingese .....	Mrs. Clark
Pomeranian .....	Mrs. Clark
Open, Red, Orange, Cream and Sable; Black,	
Brown and Blue; Any Other Allowed Color.	
Same division of classes in bitches.	
Poodle (Toy) .....	Mrs. Clark
Pugs .....	Mrs. Clark
Open, Black; Fawn. Same division of classes in	
bitches.	
Russian Toy .....	Mrs. Clark
Russian Tsvetnaya Bolonka .....	Mrs. Clark
Shih Tzu .....	Mrs. Clark
Silky Terriers .....	Mrs. Clark
Toy Fox Terriers .....	Mrs. Clark
Yorkshire Terriers .....	Mrs. Clark

## NON-SPORTING BREEDS

Mrs. Danelle M. Brown

American Eskimos .....	Mrs. Brown
Bichons Frises .....	Mrs. Brown
Boston Terriers .....	Mrs. Brown
Open, under 15 lbs.; 15 lbs and over Same	
division of classes in bitches.	
Bulldogs .....	Mrs. Brown
Chinese Shar-Pei .....	Mrs. Brown
Chow Chows .....	Mrs. Brown
Open, Black; Red; Any Other Allowed Color.	
Same division of classes in bitches.	
Coton de Tulear .....	Mrs. Brown
Dalmatians .....	Mrs. Brown
Open, Black Spotted; Liver-Spotted. Same divi-	
sion of classes in bitches.	
Finnish Spitz .....	Mrs. Brown
French Bulldogs .....	Mrs. Brown
Keeshonden .....	Mrs. Brown
Lhasa Apsos .....	Mrs. Brown
Lowchen .....	Mrs. Brown
Norwegian Lundehunds .....	Mrs. Brown
Poodles (Miniature) .....	Mrs. Clark
Poodles (Standard) .....	Mrs. Clark
Schipperkes .....	Mrs. Brown

Shiba-Inu .....	Mrs. Brown
Tibetan Spaniels .....	Mrs. Brown
Tibetan Terriers .....	Mrs. Brown
Xoloitzcuintli .....	Mrs. Brown

## HERDING BREEDS

Ms. Karen J. Hynek

Australian Cattle Dogs .....	Mrs. Redmer
Australian Shepherds .....	Mrs. Redmer
Open, Black; Blue Merle; Red Merle; Red.	
Same division of classes in bitches.	
Bearded Collies .....	Mrs. Redmer
Beauceron .....	Mrs. Redmer
Belgian Laekenois .....	Mrs. Redmer
Belgian Malinois .....	Mrs. Redmer
Belgian Sheepdogs .....	Mrs. Redmer
Belgian Tervuren .....	Mrs. Redmer
Bergamasco Sheepdogs .....	Mrs. Redmer
Berger Picard .....	Mrs. Redmer
Border Collies .....	Mrs. Redmer
Bouvier Des Flandres .....	Mrs. Redmer
Briards .....	Mrs. Redmer
Canaan Dog .....	Mrs. Redmer
Cardigan Welsh Corgis .....	Mrs. Redmer
Collies (Rough) .....	Mrs. Redmer
Open, Blue; Sable & White; TriColor; White	
Same division of classes in bitches.	
Collies (Smooth) .....	Mrs. Redmer
Entlebucher Mountain Dogs .....	Mrs. Redmer
Finnish Lapphund .....	Mrs. Redmer
German Shepherd Dogs .....	Mrs. Redmer
Icelandic Sheepdogs .....	Mrs. Redmer
Lancashire Heelers .....	Mrs. Redmer
Miniature American Shepherd .....	Mrs. Redmer
Open, Black; Blue Merle; Red Merle; Red.	
Same division of classes in bitches.	
Mudi .....	Mrs. Redmer
Norwegian Buhunds .....	Mrs. Redmer
Old English Sheepdogs .....	Mrs. Redmer
Pembroke Welsh Corgis .....	Mrs. Redmer
Polish Lowland Sheepdogs .....	Mrs. Redmer
Pulik .....	Mrs. Redmer
Pumik .....	Mrs. Redmer
Pyrenean Shepherds .....	Mrs. Redmer
Shetland Sheepdogs .....	Mrs. Redmer
Open, Sable and White; Any Other Allowed	
Color. Same division of classes in bitches.	
Spanish Water Dog .....	Mrs. Redmer
Swedish Vallhunds .....	Mrs. Redmer

## JUNIOR SHOWMANSHIP COMPETITION

Mrs. Sharon Ann Redmer

## OBEDIENCE

Beginner Novice A .....	Ms. Thornton
Beginner Novice B .....	Ms. Thornton
Novice Class A .....	Ms. Thornton
Novice Class B .....	Ms. Thornton
Novice, Graduate .....	Mr. Kozak
Novice, Preferred .....	Ms. Thornton
Open Class A .....	Mr. Kozak
Open Class B .....	Mr. Kozak
Open, Graduate .....	Mr. Kozak
Open, Preferred .....	Mr. Kozak
Utility Class A .....	Mr. Kozak
Utility Class B .....	Mr. Kozak
Utility, Preferred .....	Mr. Kozak
Versatility Class .....	Mr. Kozak
Rally Novice A .....	Ms. Thornton
Rally Novice B .....	Ms. Thornton
Rally Intermediate .....	Ms. Thornton
Rally Advanced A .....	Ms. Thornton
Rally Advanced B .....	Ms. Thornton
Rally Excellent A .....	Ms. Thornton
Rally Excellent B .....	Ms. Thornton
Rally Master .....	Ms. Thornton
Rally Choice .....	Ms. Thornton

## CLASSIFICATION

This classification applies to each breed, whose name is listed. Any change in regular or non-regular classes appears under the individual breed heading.

### REGULAR CLASSES

Puppy Dogs	Puppy Bitches
6 mos. and under 9 mos.	6 mos. and under 9 mos.
Puppy Dogs	Puppy Bitches
9 mos. and under 12 mos.	9 mos. and under 12 mos.
12 mos. and under 18 mos. Dogs	12 mos. and under 18 mos. Bitches
Novice Dogs	Novice Bitches
Amateur-Owner Handled Dogs	Amateur-Owner Handled Bitches
Bred by Exhibitor Puppy Dogs	Bred by Exhibitor Puppy Bitches
Bred by Exhibitor Adult Dogs	Bred by Exhibitor Adult Bitches
American Bred Dogs	American Bred Bitches
Open Dogs	Open Bitches
Winners Dog	Winners Bitch

### NON-REGULAR CLASSES, INVOLVING SINGLE DOG ENTRIES

Veteran (divided by sex): 7 years of age and older

### BEST OF BREED/VARIETY COMPETITION

**Best of Breed/Variety Competition** - "The following categories of dogs may be entered and shown in Best of Breed competition - Dogs that are Champions of Record- Dogs which, according to their owner's records, have completed the requirements for a championship but whose championships are unconfirmed, provided this transfer is made in writing and presented to the superintendent at least 30 minutes prior to the start of each trial. The entry and showing of dogs whose championships are unconfirmed is limited to a period of 90 days from the date of the show where a dog completed the requirements for a championship according to the owner's records. If, at the end of the 90-day period, the championship of a dog has not been confirmed by the American Kennel Club, no further entries of the dog for Best of Breed competition are to be made until its championship has been confirmed by the AKC."

### NON-REGULAR CLASSES, INVOLVING MULTIPLE DOG ENTRIES

**Stud Dog Class** - For dogs that have sired two dogs or bitches entered in this show. The award will be based on the merits of the get. The owner of the stud dog need not be the owner of the get. As the judge's decision in this class will be based on the merits of more than one dog or bitch, no one of the dogs or bitches making up the entry judged first in the class, will be eligible to compete for Best of Breed by virtue of having won this class. The Stud Dog must appear in the ring with his get and be entered in the Stud Dog Class.

**Brood Bitch Class** - For bitches that have whelped two dogs or bitches entered in this show. The award will be based on the merits of the produce. The owner of the brood bitch need not be the owner of the produce. As the judge's decision in this class will be based on the merit of more than one dog or bitch, no one of the dogs or bitches making up the entry judged first in the class will be eligible to compete for Best of Breed by virtue of having won this class. The Brood Bitch must appear in the ring with her produce and be entered in the Brood Bitch Class.

### JUNIOR SHOWMANSHIP CLASSIFICATION

Novice Junior	Novice Intermediate	Novice Senior
Open Junior	Open Intermediate	Open Senior
		Master

### OBEDIENCE CLASSIFICATION

Novice A	Open A	Utility A
Novice B	Open B	Utility B

### OPTIONAL TITLING OBEDIENCE CLASSIFICATION

Beginner Novice A	Beginner Novice B	
Graduate Novice	Graduate Open	Versatility
Preferred Novice	Preferred Open	Preferred Utility

### RALLY CLASSIFICATION

Novice A, Novice B, Intermediate, Advanced A, Advanced B, Excellent A, Excellent B, Master, Choice  
Jump Heights are required for every dog that is jumping in Obedience and/or Rally.  
Jumps will be high to low. *All-American/Mixed Breeds are allowed at these trials*

AED location will be posted

**Emergency Medical Services** provided by Community Ambulance

**Veterinarian – Friday on call, Saturday and Sunday in attendance**

Jessica Hagstette, DVM

Camino Al Norte Animal Hospital

5130 Camino Al Norte, North Las Vegas · (702) 304-8387

51 miles 1 hr 25 minutes

Monday through Friday 7am - 5pm; Saturday 8am - 5pm; Sunday 8am - 5pm

caminoalnortevet.com

*Exhibitors should follow their veterinarians' recommendation to assure their dogs are free of internal and external parasites, any communicable diseases, and have appropriate vaccinations.*

**Veterinary Emergency Group**

**OPEN 24/7**

32.8 MI

800 S Rampart Blvd,

Las Vegas, NV 89145

702.790.8242

**OPEN 24/7**

33.2 MI

470 N Stephanie St,

Henderson, NV 89014

702.529.4850

**Animal Emergency Center of Las Vegas and Henderson**

**OPEN 24/7**

40.2 miles

3340 E Patrick Ln, Las Vegas, NV 89120

702.457.8050

# NEW FOR 2026

## PHOTOGRAPHERS FOR ALL EVENTS

*“Only the listed official photographer may take win pictures.  
A win picture is defined as consisting of a judge, handler, dog and ribbons.”*

Conformation – Frank Horvath/ Showcanine

[frank@showcanine.com](mailto:frank@showcanine.com) 909-728-1938

Win photos will be available for purchase the same day at <https://showcanine.com>

No cell phone pictures to be taken over the shoulder of the official photographer

Conformation ringside shots - Kyla Turner [longdog.shootproof.com](http://longdog.shootproof.com)

LongDog Photography

GoPlayDogSports@Gmail.com

FACEBOOK: Long Dog Photography

INSTAGRAM: LongDog.Photography

Obedience and Rally - Tiffany Flores

[tiffanyfphotography.com](http://tiffanyfphotography.com)

---

## VENDORS WILL BE INDOORS

Want to join us? Have a question?

Contact

Julie Troxel [julietroxel@icloud.com](mailto:julietroxel@icloud.com)

Text preferred 702-540-4230

## **SATURDAY**

### **BEST IN SHOW & VARIETY GROUP PRIZES**

#### **Best In Show**

Collapsible Rolling Cooler with SSKC logo Offered by Cheryl Schnell, Bel Amour Bichons  
3 large bags of dog food plus branded item Offered by Farmina

#### **Reserve Best In Show**

Ringside Tote Bag Offered by David H. Butterfield MLT/ASCP, & Gary C. Sackett, Crown Royal  
Westies in Memory of CH Crown Royal's King Philip "Pinkie"

#### **Best Owner-Handled In Show**

Rally Towel w/ Logo Offered by Connie Romano  
Rosette Offered by Silver State Kennel Club  
3 large bags of dog food plus branded item Offered by Farmina

#### **Reserve Best Owner-Handled In Show**

Ryobi Clamp Fan offered by Pia and Jason Valle, Vegas Valle Beagles  
Rosette Offered by Silver State Kennel Club

#### **Best Bred-By-Exhibitor In Show**

One free AKC litter registration Offered by The American Kennel Club  
Rosette Offered by Silver State Kennel Club

#### **Best 4-6 Month Puppy In Show**

Puppy Toy Basket Offered by Mikey Patane & AJ Tkaczuk in Memory of Madison  
1 large bag of dog food Offered by Farmina  
Rosette Offered by Silver State Kennel Club

#### **Sporting Group First**

Rally Towel w/ Logo and Spray Bottle Offered by Lorelee Wood, Coldwell Banker Premier Realty  
1 large bag of dog food Offered by Farmina

#### **Hound Group First**

Rally Towel w/ Logo and Spray Bottle Offered by Jason and Pia Valle, Vegas Valle Beagles  
1 large bag of dog food Offered by Farmina

#### **Working Group First**

Rally Towel w/ Logo and Spray Bottle offered by ICSB NV at Camino al Norte Animal Hospital  
1 large bag of dog food Offered by Farmina

#### **Terrier Group First**

Rally Towel w/ Logo and Spray Bottle Offered by Cheryl Gearhart, Ravensroost, In Memory of  
Mr. Chips CG SE "SofaBoy"  
1 large bag of dog food Offered by Farmina

#### **Toy Group First**

Rally Towel w/ Logo and Spray Bottle Offered by Linda Sue Brown

1 large bag of dog food Offered by Farmina

**Non-Sporting Group First**

Rally Towel w/ Logo and Spray Bottle Offered by Kayla Macko

1 large bag of dog food Offered by Farmina

**Herding Group First**

Rally Towel w/ Logo and Spray Bottle Offered by Darlene Cross

1 large bag of dog food Offered by Farmina

**For First in Each Regular Group**

Rosette offered by Silver State Kennel Club

**For Second, Third & Fourth in Each Regular Group**

Rosette offered by Silver State Kennel Club

1 small bag of dog food Offered by Farmina

**For First in Each Owner-Handled Variety Group**

Rosette offered by Silver State Kennel Club

1 large bag of dog food Offered by Farmina

**For Second, Third & Fourth in Each Owner-Handled Variety Group**

Rosette offered by Silver State Kennel Club

1 small bag of dog food Offered by Farmina

**SATURDAY**

**BREED/VARIETY PRIZES**

**HOUND BREEDS**

**Smooth Dachshund - Best of Breed**

Breed Specific Item Offered by Alex Hooper, Briswood Kennels

**Wire-Haired Dachshund - Best of Breed**

Breed Specific Item Offered by Joan Kelly, Doxie Lover Dachshunds, In Memory of Our beloved Bigboy and Shadow, You will be missed forever.

**Portuguese Podengo Pequeno - Best of Breed**

Breed Specific Item Offered by Barbara Alexander

**WORKING BREEDS**

**Rottweiler - Best of Breed**

Breed Specific Item Offered by Alex Hooper, Briswood Kennels

**TERRIER BREEDS**

**Standard Manchester Terriers – Best of Breed**

Breed Specific Item Offered by Dr. Kristi M Kaminsky and Dr. Mallory Eckstut

**Scottish Terriers – Best of Breed**

Breed Specific Item Offered by Connie Kling, Muirfield, in Memory of Barry Gambarana

**Scottish Terriers – Best of Winners**

Breed Specific Item Offered by Connie Kling, Muirfield, in Memory of Barry Gambarana

**Scottish Terriers – Best Opposite Sex**

Breed Specific Item Offered by Connie Kling, Muirfield, in Memory of Barry Gambarana

**West Highland White Terriers – Best of Breed**

Breed Specific Item Offered by Dr. Roxanna Twedt, Elvador Westies

**NON-SPORTING BREEDS**

**French Bulldog – Best of Winners**

Breed Specific Item Offered by Lorraine Jacintho, Bonjour Bullies

**Poodles (Miniature) – Best of Variety**

\$15 Offered by the Poodle Club of Las Vegas

**Poodles (Standard) – Best of Variety**

\$15 Offered by the Poodle Club of Las Vegas

**Standard Poodle – Winners Dog**

Breed Specific Item Offered by Susie Osburn, Lido Poodles, in Memory of Lidos Kisses for  
Sunshine

**Standard Poodle – Winners Bitch**

Breed Specific Item Offered by Susie Osburn, Lido Poodles, in Memory of Lidos Kisses for  
Sunshine

**TOY BREEDS**

**Smooth Chihuahua – Best of Winner's**

Breed Specific Item offered by Terry & Randy Stackhouse, Casa de Chihuahua

**Poodles (Toy) – Best of Variety**

\$15 Offered by the Poodle Club of Las Vegas

**HERDING BREEDS**

The American Belgian Malinois Club supports the entry.

**Belgian Malinois – Best of Breed**

Breed Specific Item offered by Dr. Kristi M Kaminsky and Dr. Mallory Eckstut

**Australian Shepherds – Best of Breed**

Breed Specific Item offered by Dr. Kristi M Kaminsky and Dr. Mallory Eckstut

**SPECIAL THANKS TO OUR SPONSORS OF THE GENERAL FUND**

David H Butterfield, Gary Sackett & Linda Westlund, Crown Royal Westies

Jason and Pia Valle, Vegas Valle Beagles

Sandy and Lee Brannum, Hampton Court

Sherry Graff, In Memory of Kona & Chloe

Mikey Patane & AJ Tkaczuk  
Mary Sahady  
Peggy Metcalf  
Kayla Macko  
Geri Hunt  
ICSB at Camino al Norte Hospital  
The Las Vegas K9 Foundation

### **JUNIOR SHOWMANSHIP COMPETITION PRIZES**

#### **Best Junior Handler**

\$35.00 Gift Card offered by Mary Sahady, Ashgate US, In Loving Memory of Kenzie, our Scottish Terrier forever in our hearts  
Chocolate plus Branded items Offered by Farmina  
Rosette Offered by Silver State Kennel Club

#### **Reserve Best Junior Handler**

\$25.00 Gift Card offered by Peggy Metcalf, Flurries Norfolk Terriers, In Memory of Flurries Rose Island Light CGC FDC BN RECA BCAT TKI RATN CG ME  
Rosette Offered by Silver State Kennel Club

A trophy card for sponsored awards will be at the ring.

Please present it at the trophy table located by the stage to receive your trophy.



## **SUNDAY**

### **BEST IN SHOW & VARIETY GROUP PRIZES**

#### **Best In Show**

Collapsible Rolling Cooler with SSKC logo Offered by The Las Vegas K9 Foundation  
3 large bags of dog food plus branded item Offered by Farmina

#### **Reserve Best In Show**

Ringside Tote Bag Offered by Sandy and Lee Brannum, Hampton Court

#### **Best Owner-Handled In Show**

Rally Towel w/ Logo Offered by Cindy Muller & Kimberly Vonk, Lndi's Border Terriers  
Rosette Offered by Silver State Kennel Club  
3 large bags of dog food plus branded item Offered by Farmina

#### **Reserve Best Owner-Handled In Show**

Ryobi Clamp Fan offered by Sherry Graff in Memory of Kona and Chloe  
Rosette Offered by Silver State Kennel Club

#### **Sporting Group First**

Dog First Aid Kit Offered by Loralee Wood, Coldwell Banker Premier Realty  
1 large bag of dog food Offered by Farmina

#### **Hound Group First**

Dog First Aid Kit Offered by Jason and Pia Valle, Vegas Valle Beagles  
1 large bag of dog food Offered by Farmina

#### **Working Group First**

Dog First Aid Kit Offered by ICSB NV at Camino al Norte Animal Hospital  
1 large bag of dog food Offered by Farmina

#### **Terrier Group First**

Dog First Aid Kit Offered by Cheryl Gearhart, Ravensroost In Memory of Mr. Chips CG SE  
"SofaBoy"  
1 large bag of dog food Offered by Farmina

#### **Toy Group First**

Dog First Aid Kit Offered by Linda Sue Brown  
1 large bag of dog food Offered by Farmina

#### **Non-Sporting Group First**

Dog First Aid Kit Offered by Kayla Macko  
1 large bag of dog food Offered by Farmina

#### **Herding Group First**

Dog First Aid Kit Offered by John & Karen Vornsand, In Honor of CH Crown Royal's Robert the Bruce "Stirling" 1 large bag of dog food Offered by Farmina

**For First in Each Regular Group**

Rosette offered by Silver State Kennel Club

**For Second, Third & Fourth in Each Regular Group**

Rosette offered by Silver State Kennel Club

1 small bag of dog food Offered by Farmina

**For First in Each Owner-Handled Variety Group**

Rosette offered by Silver State Kennel Club

1 large bag of dog food Offered by Farmina

**For Second, Third & Fourth in Each Owner-Handled Variety Group**

Rosette offered by Silver State Kennel Club

1 small bag of dog food Offered by Farmina

**SUNDAY  
BREED/VARIETY PRIZES**

**HOUND BREEDS**

**Smooth Dachshund - Best of Breed**

Garment Bag w/ SSKC Logo Offered by Alex Hooper, Briswood Kennels

**Wirehaired Dachshund - Best of Breed**

Garment Bag w/ SSKC Logo Offered by Joan Kelly, Doxie Lover Dachshunds, In Memory of Our beloved Bigboy and Shadow, You will be missed forever.

**Portuguese Podengo Pequeno - Best of Breed**

Garment Bag w/ SSKC Logo Offered by Barbara Alexander

**WORKING BREEDS**

**Dogue De Bordeaux - Best of Breed**

Garment Bag w/ SSKC Logo Offered by Toni Young, Rogue Bordeaux

**Rottweiler - Best of Breed**

Garment Bag w/ SSKC Logo Offered by Alex Hooper, Briswood Kennels

**TERRIER BREEDS**

**Standard Manchester Terriers – Best of Breed**

Garment Bag w/ SSKC Logo Offered by Dr. Kristi M Kaminsky and Dr. Mallory Eckstut

**Scottish Terriers – Best of Breed**

Garment Bag w/ SSKC Logo Offered by Connie Kling, Muirfield, in Memory of Barry Gambarana

**Scottish Terriers – Best of Winners**

Breed Specific Item Offered by Connie Kling, Muirfield, in Memory of Barry Gambarana

**Scottish Terriers – Best Opposite Sex**

Breed Specific Item Offered by Connie Kling, Muirfield, in Memory of Barry Gambarana

**West Highland White Terriers – Best of Breed**

Breed Specific Item Offered by Dr. Roxanna Twedt, Elvador Westies

**NON-SPORTING BREEDS**

**French Bulldog – Best of Winners**

Breed Specific Item Offered by Lorraine Jacintho, Bonjour Bullies

**Poodles (Miniature) – Best of Variety**

\$15 Offered by the Poodle Club of Las Vegas

**Poodles (Standard) – Best of Variety**

\$15 Offered by the Poodle Club of Las Vegas

**Standard Poodle – Winners Dog**

Breed Specific Item Offered by Susie Osburn, Lido Poodles, in Memory of Lidos Kisses for Sunshine

**Standard Poodle – Winners Bitch**

Breed Specific Item Offered by Susie Osburn, Lido Poodles, in Memory of Lidos Kisses for Sunshine

**TOY BREEDS**

**Smooth Chihuahua – Best of Winners**

Breed Specific Item offered by Sherry Graff, In Memory of Kona and Chloe

**Poodles (Toy) – Best of Variety**

\$15 Offered by the Poodle Club of Las Vegas

**HERDING BREEDS**

The American Belgian Malinois Club supports the entry.

**Belgian Malinois – Best of Breed**

Garment Bag w/ SSKC Logo offered by Dr. Kristi M Kaminsky and Dr. Mallory Eckstut

**Australian Shepherds – Best of Breed**

Garment Bag w/ SSKC Logo offered by Dr. Kristi M Kaminsky and Dr. Mallory Eckstut

**SPECIAL THANKS TO OUR SPONSORS OF THE GENERAL FUND**

David H Butterfield, Gary C. Sackett & Linda Westlund, Crown Royal Westies

Jason and Pia Valle, Vegas Valle Beagles

Sandy and Lee Brannum, Hampton Court

Sherry Graff, In Memory of Kona & Chloe

Mikey Patane & AJ Tkaczuk  
Mary Sahady  
Peggy Metcalf  
Kayla Macko  
Geri Hunt  
ICSB at Camino al Norte Hospital  
The Las Vegas K9 Foundation

### **JUNIOR SHOWMANSHIP COMPETITION PRIZES**

#### **Best Junior Handler**

\$35.00 Gift Card offered by Mary Sahady, Ashgate US, In Loving Memory of Kenzie, our Scottish Terrier forever in our hearts  
Chocolate plus Branded Items Offered by Farmina  
Rosette Offered by Silver State Kennel Club

#### **Reserve Best Junior Handler**

\$25.00 Gift Card offered by Peggy Metcalf, Flurries Norfolk Terriers, In Memory of Flurries Rose Island Light CGC FDC BN RECAV BCAT TKI RATN CG ME  
Rosette Offered by Silver State Kennel Club

A trophy card for sponsored awards will be at the ring.

Please present it at the trophy table located by the stage to receive your trophy.

## **SATURDAY OBEDIENCE TRIAL PRIZES**

Qualifying score required for all prizes in Titling Classes.  
A Dark Green Qualifying Ribbon will be awarded to each dog attaining a Qualifying Score.

### **First Place**

Dog Toy Offered by Members of the Silver State Kennel Club

### **Highest Scoring Dog In Regular Classes**

Dog First Aid Kit offered by the Las Vegas K9 Foundation

1 large bag of dog food Offered by Farmina

Rosette Offered by Silver State Kennel Club

### **Highest Combined Score In Open B & Utility B Classes**

Dog First Aid Kit offered by the Las Vegas K9 Foundation

Rosette Offered by Silver State Kennel Club

### **Highest Scoring Local Dog In Regular Classes** (resident of Clark County)

Rally Towel w/ Logo Offered by Ginger Austin

Rosette Offered by Silver State Kennel Club

## **RALLY TRIAL PRIZES**

Qualifying score required for all prizes in Titling Classes.  
A Dark Green Qualifying Ribbon will be awarded to each dog attaining a Qualifying Score

### **First Place**

Dog Toy Offered by Members of the Silver State Kennel Club

### **Highest Scoring Triple Qualifying Score**

Dog First Aid Kit offered by the Las Vegas K9 Foundation

1 large bag of dog food Offered by Farmina

Rosette Offered by Silver State Kennel Club

### **Highest Combined Score in Advanced B & Excellent B Classes**

Dog First Aid Kit offered by the Las Vegas K9 Foundation

Rosette Offered by Silver State Kennel Club

A trophy card for sponsored awards will be at the ring.

Please present it at the trophy table located by the stage to receive your trophy.

## **SUNDAY OBEDIENCE TRIAL PRIZES**

Qualifying score required for all prizes in Titling Classes.  
A Dark Green Qualifying Ribbon will be awarded to each dog attaining a Qualifying Score.

**First Place**

Dog Toy Offered by Members of the Silver State Kennel Club

**Highest Scoring Dog In Regular Classes**

Garment Bag w/ SSKC Logo offered by the Las Vegas K9 Foundation  
1 large bag of dog food Offered by Farmina  
Rosette Offered by Silver State Kennel Club

**Highest Combined Score In Open B & Utility B Classes**

Garment Bag w/ SSKC Logo offered by the Las Vegas K9 Foundation  
Rosette Offered by Silver State Kennel Club

**Highest Scoring Local Dog In Regular Classes** (resident of Clark County)

Rally Towel w/ Logo Offered by Ginger Austin  
Rosette Offered by Silver State Kennel Club

**RALLY TRIAL PRIZES**

Qualifying score required for all prizes in Titling Classes.  
A Dark Green Qualifying Ribbon will be awarded to each dog attaining a Qualifying Score

**First Place**

Dog Toy Offered by Members of the Silver State Kennel Club

**Highest Scoring Triple Qualifying Score**

Garment Bag w/ SSKC Logo offered by the Las Vegas K9 Foundation  
1 large bag of dog food Offered by Farmina  
Rosette Offered by Silver State Kennel Club

**Highest Combined Score in Advanced B & Excellent B Classes**

Garment Bag w/ SSKC Logo offered by the Las Vegas K9 Foundation  
Rosette Offered by Silver State Kennel Club

A trophy card for sponsored awards will be at the ring.

Please present it at the trophy table located by the stage to receive your trophy.



# Join The Exclusive Club

*Dedicated To Professional Breeders.*



**SCAN HERE** for more information  
Or Email Dawn Bell at [d.bell@farmina.com](mailto:d.bell@farmina.com)

[farmina.com](http://farmina.com)



## Silver State KC Show

March 21-22, 2026

- ❖ **Best In Show**- 3 Large Bags of Food & Branded Item
- ❖ **Group 1<sup>st</sup> Winners** - Large Bag of Food
- ❖ **Group 2<sup>nd</sup>-4<sup>th</sup>** - Small Bag of Food
- ❖ **Best in Show Owner Handled**- 3 Large Bags of Food & Branded Item
- ❖ **OH Group 1<sup>st</sup> Winners** - Large Bag of Food
- ❖ **OH Group 2<sup>nd</sup>-4<sup>th</sup>** - Small Bag of Food
- ❖ **Best Jr Handler** - Chocolate & Branded Items
- ❖ **Beginner Puppy 4-6 Months**- Large Bag of Food
- ❖ **High-In Trial Obedience** - Large Bag of Food
- ❖ **High Triple Qualifying Rally** - Large Bag of Food
- ❖ **FSS Open – Best in Show** - Large Bag of Food



**THE AMERICAN BELGIAN MALINOIS CLUB**  
**WILL SUPPORT THE ENTRY OF BELGIAN MALINOIS AT THIS SHOW**  
**SATURDAY**

Conformation

The Pacific Malinois Club offers a Rosette for Best of Breed, Best of Opposite Sex to Best of Breed, Best of Winners, Winners Dog, Winners Bitch, Reserve Winners Dog, Reserve Winners Bitch, Select Dog, Select Bitch & Best Owner-Handled.

The following prizes are offered by the American Belgian Malinois Club.

**Best of Breed.**

AMBC Garment Bag.

**Best of Opposite Sex to Best of Breed.**

AMBC Garment Bag.

**Best of Winners.**

Dog Toy.

**Winners Dog & Bitch.**

AMBC Garment Bag.

**Reserve Winners Dog & Bitch.**

AMBC Garment Bag.

**Select Dog & Bitch.**

AMBC Garment Bag.

**Best Owner-Handled.**

Dog Toy.

Obedience

**Highest Scoring Belgian Malinois in Regular Obedience Classes.** Rosette & Dog Toy.

**Each Belgian Malinois Receiving a Qualifying Score.** Dog Toy.

Rally

**Each Belgian Malinois Receiving a Qualifying Score.** Dog Toy.

## **SUNDAY**

### Conformation

**The Pacific Malinois Club** offers a Rosette for Best of Breed, Best of Opposite Sex to Best of Breed, Best of Winners, Winners Dog, Winners Bitch, Reserve Winners Dog, Reserve Winners Bitch, Select Dog, Select Bitch & Best Owner-Handled.

The following prizes are offered by the American Belgian Malinois Club.

#### **Best of Breed.**

AMBC Mug.

#### **Best of Opposite Sex to Best of Breed.**

AMBC Mug.

#### **Best of Winners.**

ABMC Mug.

#### **Winners Dog & Bitch.**

Dog Toy.

#### **Reserve Winners Dog & Bitch.**

Dog Toy.

#### **Select Dog & Bitch.**

AMBC Mug.

#### **Best Owner-Handled.**

AMBC Garment Bag.

### Obedience

**Highest Scoring Belgian Malinois in Regular Obedience Classes.** Rosette & Dog Toy.

**Each Belgian Malinois Receiving a Qualifying Score.** Dog Toy.

### Rally

**Each Belgian Malinois Receiving a Qualifying Score.** Dog Toy.

## **Pee Wee Class – Saturday, time announced in judging program (Geared for children ages 5-9; Saturday Only)**

Consult Judging Program for meeting place & time  
Entries taken day of show until 10:00AM, Saturday  
Judge: Sharon Redmer  
Entries limited to 15  
Entry fee: Free

Each Pee Wee unit consists of the child, their responsible adult, and the dog. Only one Pee Wee unit is in the ring at a time. This is not a competitive class, but rather a fun, learning experience for the child and the adult.

A dog must be at least four months of age to enter the Pee Wee class.

All dogs entered must have the proper lead and collar.

A responsible adult must be present with the child both inside and outside the ring. The adult is to maintain control of the dog outside of the ring.

Dogs that are allowed: AKC fully recognized, Miscellaneous Class breeds, PAL listings, FSS breeds, and All-American

A release must be signed by the child's parent or legal guardian. Pee Wee Release of Liability will be available at the show. A time and ring will be listed in the judging program.

The entry fee has been waived by the club. There is no cost for this event. Entries will be accepted on the day of the event.

The safety of the dog and child inside and outside the ring is a primary concern. Outside of the ring, the dog is to be controlled by the adult accompanying the child. At the Judge's discretion based upon the size of the child and the dog, for safety purposes the adult may be asked to attach a second lead to the dog so both child and adult will walk the dog together.

Although the word "judge" will be used, this is designed to be a learning and mentoring experience. No Pee Wee will be "judged" but rather will be mentored with the age-appropriate amount of information to help prepare them for what they will be expected to know about AKC regular Junior Showmanship once they reach 9 years of age. The children will be mentored.

One child, their adult, and dog in the ring at a time. Each child will receive a participation ribbon to commemorate the experience.

There is no pre-entry, but we would like to know the number of Pee Wee participants to expect. Please send an email with the participant's name and adult's name by March 4, 2026.

**To make a reservation, and for any questions regarding this  
Special Attraction, please contact:  
Julie Troxel [julietroxel@icloud.com](mailto:julietroxel@icloud.com)  
Text preferred 702-540-4230**

## SATURDAY & SUNDAY NOHS JUDGING

The AKC National Owner-Handled Series is a non-titling competition for dogs that are exhibited by their owners that are not professional handlers.

Exhibitors must declare their dog is Owner-Handled eligible at the time of entry on the entry form. Dogs entered in the Amateur-Owner-Handler class will automatically be marked as eligible to compete in the NOHS. Eligible dogs will be identified by an asterisk in the judge's book, steward's book & the catalog. **Dogs must be handled throughout the breed level competition for the regular show by an eligible owner. Professional handlers\*, household members and current assistants\*\* to professional handlers may not exhibit the dog in any NOHS competition during the entire show.**

Owner-Handled Best of Breed will be selected from the dogs that are eligible to compete in the Best of Breed competition including Winners Dog, Winners Bitch and winners of the non-regular classes.

- If the Best of Breed/Variety winner is Owner-Handled competition eligible, it will automatically be Owner-Handled Best of Breed/Variety and be eligible to compete in both the regular as well as the Owner-Handled group.

- If the Best of Breed/Variety winner is not eligible for Owner-Handled competition and the Best of Opposite Sex to Best of Breed/Variety is eligible, the Best of Opposite Sex to Best of Breed/Variety will compete against the eligible exhibits of the other sex to determine Owner-Handled Best of Breed/Variety.

- If neither the Best of Breed nor the Best of Opposite Sex to Best of Breed/Variety are Owner-Handled competition eligible and Select Dog & Select Bitch are both eligible, the judge is to choose Best Owner-Handled exhibit from the Selects and eligible Winners Dog or Winners Bitch.

- If one of the Selects is eligible, excuse all Champions and non-regular class winners of the same sex and then choose Best Owner-Handled exhibit from the remaining dogs of the opposite sex including the eligible Winners.

- If Best of Breed, Best of Opposite Sex to Best of Breed, Select Dog & Select Bitch are not eligible, the judge may choose any eligible dog remaining in the ring including Winners Dog or Winners Bitch as Owner-Handled Best of Breed/Variety.

- If the Best of Winners is eligible, the other Winner is ineligible since it was defeated.

- No class dogs other than the Winners Dog & Winners Bitch are eligible to return to the ring.

The breed will not be represented in the Owner-Handled Group if there is no eligible dog competing in the Best of Breed or in Best of Winners competition.

*\*Professional handlers are defined as any person who belongs or has belonged to a professional handlers' organization, distributed rate cards, or otherwise advertised or represented themselves as handling dogs for pay within the last five years*

**\*\*A current assistant is defined as anyone employed by a professional handler on a full-time basis, or assisting a professional handler at the show or any time during the cluster/weekend. Current assistants that are eligible to compete in Junior Showmanship (meet age & amateur status requirements) may participate in NOHS. .AKC Revised 5/11/18**

JUDGES	SATURDAY	SUNDAY
Sporting	Ms. Hynek	Mrs. Brown
Hounds	Mrs. Redmer	Ms. Hynek
Working	Ms. Graham	Mrs. Clark
Terriers	Mr. Peat	Ms. Dean
Toys	Mr. Peat	Mrs. Brown
Non-Sporting	Mrs. Clark	Mrs. Redmer
Herding	Ms. Dean	Mrs. Redmer
BISOH	Mrs. Brown	Mr. Peat

## **BRED-BY-EXHIBITOR • SATURDAY • BREED, GROUP, BEST IN SHOW**

Competition is offered for dogs & bitches entered and exhibited in the bred-by-exhibitor classes of each age group to compete for Best of Breed Bred-By-Exhibitor through Best in Show Bred- By-Exhibitor. Dogs that win Best of Breed or Best of Winners from a Bred by Exhibitor class in the regular conformation classes are automatically Best of Breed Bred-By-Exhibitor.

Open to dogs & bitches entered in the Bred-by-Exhibitor Class on Saturday.

Bred by Exhibitor Classes Divided, both Sexes: 6-12 Mos., 12 Mos. & Older Competition for Best of Breed Bred-by-Exhibitor will be held after the completion of each breed. The schedule for Bred-by-Exhibitor group time and judge will be published in the judging program. Competition for Best in Show Bred-by-Exhibitor will take place just prior to the regular Best in Show judging. Entry for Best of Breed Bred-by-Exhibitor is automatic for dogs & bitches that win first place in the regular Bred-by-Exhibitor Class. Throughout competition, dogs & bitches must be shown by persons eligible for the Bred-by-Exhibitor Class as defined in Chapter 3, Section 7, of the Rules Applying to Dog Shows published by The American Kennel Club. In the event the Best of Breed or Best of Winners is awarded to a dog or bitch that was first in the Bred- by-Exhibitor class that dog or bitch will automatically be the Best of Breed Bred-by-Exhibitor. If the winner of a Bred-by-Exhibitor Class is not present for Best Bred-by-Exhibitor or Bred-by-Exhibitor Group competition, second place dogs or bitches may not compete in its place.

- Best Bred-By Exhibitor – the Bred-by-Exhibitor class including the Bred-by-Exhibitor Puppy and Bred-by-Exhibitor Adult age divisions. AKC effective 08/20/23

## JUNIOR SHOWMANSHIP COMPETITION

**Novice Junior Class:** For Boys and Girls who are at least 9 years old and under 12 years old on the day of the show and who, at the time entries close, have not won three First Place awards with competition present in a Novice Class at a licensed or member show.

**Novice Intermediate Class:** For Boys and Girls who are at least 12 years old and under 15 years old on the day of the show and who, at the time entries close, have not won three First Place awards with competition present in a Novice Class at a licensed or member show.

**Novice Senior Class:** For Boys and Girls who are at least 15 years old and under 18 years old on the day of the show and who, at the time entries close, have not won three First Place awards with competition present in a Novice Class at a licensed or member show.

**Open Junior Class:** For Boys and Girls who are at least 9 years old and under 12 years old on the day of the show and who, at the time entries close, have won three First Place awards with competition present in a Novice Class at a licensed or member show.

**Open Intermediate Class:** For Boys and Girls who are at least 12 years old and under 15 years old on the day of the show and who, at the time entries close, have won three First Place awards with competition present in a Novice Class at a licensed or member show.

**Open Senior Class:** For Boys and Girls who are at least 15 years old and under 18 years old on the day of the show and who, at the time entries close, have won three First Place awards with competition present in a Novice Class at a licensed or member show.

**Master Class:** This class will be for boys and girls who are at least 9 years old and under 18 years on the day of the show, and who have won 10 Best Junior wins with competition. The calendar for this class will be consistent with the eligibility dates for the AKC National Championship. All Juniors Meeting the criteria for this class are required to enter the Master Class and may change their entry the day of the show if entries have already closed. Once the eligibility time frame for that year has passed all participants return to the Open Class to compete for the following year.

Junior Handlers who win a third Novice Class with competition present after the closing of entries for a show may transfer their entry from the Novice Class to the Open Class provided that this transfer is made by the Superintendent at least one half-hour prior to the scheduled start of any regular conformation judging or one half-hour prior to the scheduled start of Junior Showmanship judging at the show, whichever is earlier.

Winning of first place in an Open Class at this show may qualify or count toward qualification for entry in certain future limited Junior Showmanship Classes. For information on eligibility requirements for limited Junior Showmanship Classes which have been approved to date by AKC, go online at [www.akc.org](http://www.akc.org).

Junior Handler's must include their AKC Junior Handler identification number on the entry blank. You may obtain your number by calling the AKC Event Records Department (919) 233-9767.

Notice: Be sure all information for Junior Showmanship Classes is entered on the front and back of the entry form.

## BEST JUNIOR HANDLER SCHOLARSHIP AWARD SATURDAY & SUNDAY



The members of the Silver State Kennel Club (SSKC) are pleased to announce the creation of the Silver State Kennel Club Scholarship Fund.

In order to support the future education of Junior Handlers who are participating in the Sport of Dogs, a \$500.00 Scholarship Certificate will be offered by SSKC to the Best Junior Handler on both Saturday and Sunday.

*These Scholarship Certificates may be redeemed for any of the following purposes:*

*To enter & participate in the AKC National Championship Dog Show presented by Royal Canin.*

*To enter & participate in the Westminster Kennel Club Dog Show.*

*To enter & participate in a National Breed Specialty Show.*

*To attend an accredited, approved, post-secondary educational institution.*

For Entry/Participation in the AKC National Championship presented by Royal Canin, Westminster or a National Specialty Dog Show:

Upon appropriate notification including a copy of a document verifying registration in one of the aforementioned shows, the SSKC will disperse the \$500.00 scholarship money directly to the recipient. For Attendance at an accredited, approved, post-secondary educational institution:

Upon appropriate notification including a copy of a document of registration and a point of contact at the post-secondary educational institution, the SSKC will disperse the scholarship money directly to the recipient's institution of choice OR with appropriate receipts the \$500.00 may be dispersed to the student directly for books, academic supplies and/or materials at the discretion of the SSKC Board of Directors.

### Definitions & Limitations:

The recipient must redeem the Scholarship Certificate(s) by age 18 if using it to enter & participate in any of the aforementioned dog shows.

If used for higher education, the recipient must redeem the Scholarship Certificate(s) by age 25 or the monies will be forfeited and placed back into the Silver State Kennel Club Scholarship Fund.

If for any reason the Junior Handler is disqualified from their win, the scholarship Certificate will be considered void.

An accredited, approved, post-secondary education institution is generally considered to be a college or university of higher education. Each institution must be approved by SSKC. Other technical or trade schools will be considered, evaluated and approved by SSKC on a case-by-case basis.

Scholarship Certificates must be kept responsibly in a safe place. They are considered by SSKC to have value & must be physically redeemed by the specific individual it is issued in order to be used.



Specialty Show – Friday March 20, 2026

Licensed by the American Kennel Club • Indoors • Unbenched  
SHOW HOURS –7:00AM to 6:00PM

### OFFICERS

President .....Alexy Rollins  
Vice President ..... Harmony Leavitt  
Treasurer .....Stephen Hagstette  
Secretary ..... Jessica Hagstette

HC 38 Box 96, Las Vegas, NV , 89124

### BOARD OF DIRECTORS

Alexy Rollins, Harmony Leavitt, Jessica Hagstette, Stephen Hagstette

### SHOW COMMITTEE

Alexy Rollins – Show Chair

6624 Brooklyn Heights St., Las Vegas, NV 89166 [alexey.rollins@calloyalty.com](mailto:alexey.rollins@calloyalty.com) 702-806-3147

Officers of the club and members of the board of directors

### COMMITTEES

Alexy Rollins and Harmony Leavitt..... Hospitality, Trophies, Advertising  
Ring Steward ..... Anita Koss

### JUDGES

Mrs. Marissa L. Clark, 3522 115th Ave NW, Gig Harbor, WA 98335

### ***NOHS is not offered at this event***

Note: Superintendent, Photographer, Veterinarian, Parking, Classification, Entry Fees, Ribbons,  
and all rules relating to the grounds for this event will follow the host club

The Golden Retriever Club of Southern Nevada offers ribbons for non-regular class and regular  
placements, and rosettes above placements.

Additional rosettes are offered for:

Best Bred by from the regular bred by class

Trophies: BOB, BOW, BOS, Select, Winners, Reserve, First place regular class, Best Bred by –  
Custom Magnet





51<sup>st</sup>, 52<sup>nd</sup>, 53<sup>rd</sup> Specialty Shows

Licensed by the American Kennel Club • Indoors • Unbenched – Limit of 100 entries

# 1 SPECIALTY SHOW with Sweepstakes FRIDAY, MARCH 20, 2026

# 2 SPECIALTY SHOW FRIDAY, MARCH 20, 2026

CONCURRENT SPECIALTY SHOW SATURDAY, MARCH 21, 2026

SHOW HOURS –7:00AM to 6:00PM

**OFFICERS**

President ..... Julie Burrus  
Vice President ..... Judy Martin  
Treasurer ..... Jessica Lavender  
Secretary ..... Barbara Moler

5656 White Cap St., Las Vegas, NV 89110

**BOARD OF DIRECTORS**

Colette Hayes, Shannon Walsh

**SHOW COMMITTEE**

Julie Burrus – Show Chair

5901 Alimar Dr., Las Vegas, NV 89130 [julie501@aol.com](mailto:julie501@aol.com) 702-283-1812

Officers of the club and members of the board of directors

**COMMITTEES**

GDCLV ..... Hospitality, Trophies, Advertising  
Ring Steward ..... Judy Martin

**JUDGES**

Mr. Dave Peat..... 10360 E. Raintree Dr, Scottsdale, AZ 85255  
Friday Show #1

Ms. Lorraine Matherly ..... 2232 Chatsworth Court, Henderson, NV 89074  
Friday Show #1 Sweepstakes

Ms. Carol Graham ..... 292201 TWP Rd 262-A, Rocky View, AL T4A 0N2 Canada  
Friday Show #2

Ms. Diane Collings..... 108 Harbor Dr, Novato, CA 94945  
Saturday Concurrent Specialty Show

***NOHS is not offered at these events***

Note: Superintendent, Photographer, Veterinarian, Parking, Classification, Entry Fees, Ribbons, and all rules relating to the grounds for this event will follow the host club

The Great Dane Club of Las Vegas offers ribbons for non-regular class., and rosettes for all regular classes and above placements.

Additional rosettes are offered for:

Award of Merit (per every 6 specials, up to 2 at the discretion of the judge) dark green

Best Puppy from the regular puppy class dark green

Best Bred by from the regular bred by class # 2 show only dark green

Best Veteran from the veteran class # 1 show only dark green

Best In Sweepstakes # 1 show only green and pink

Best of Opposite Sex In Sweepstakes # 1 show only lavender

Sweepstakes # 1 show Friday only

The Sweepstakes is open to all Great Danes who are at least 6 months of age and under 18 months of age at the time of the Specialty. Dogs entered in a Sweepstakes class must be entered in one of the Regular Classes at the regular entry fee and on the regular entry form. Indicate your Sweepstakes Class with the age division in the space provided for "Additional Class." **NO CHAMPIONS OF RECORD MAY BE ENTERED IN THE SWEEPSTAKES.** Dogs entered in the Sweepstakes may be shown by anyone in good standing with the American Kennel Club.

Sweepstakes Classes (divided by sex): 6 & under 9 mos., 9 & 12 mos., 12 & under 18 mos.

Division of Sweepstakes Entry Money

35% of the total Sweepstakes entry fees will be retained by the Great Dane Club of Las Vegas to defray expenses. The remaining 65% will be divided as follows:

Best in Sweeps            35% of Sweepstakes Entries

BOS in Sweeps           30% of Sweepstakes Entries

All First Place Class Winners will compete for Best in Sweepstakes and Best of Opposite Sex to Best in Sweepstakes

## **VETERAN CLASSES**

Specialty Classes will follow the all breed classification with the exception of Veteran classes being split 6 years and under 8 years, 8 years and older

## **PARADE OF VETERANS (FRIDAY SHOW #1)**

A non-competitive class for Great Dane Veteran dogs and bitches that are six (6) years of age and older. Each entrant will receive a Rosette. The entry blank must have "Parade of Veterans" as class or as an additional entry, but entrants are not required to enter another class.

## **PARADE OF TITLEHOLDERS (FRIDAY SHOW #2)**

Eligibility: A non-competitive class for Great Dane dogs and bitches that are AKC Champions of Record and/or Obedience titled. Each entrant will receive a Rosette. The entry blank must have "Parade of Titleholders" as class or as an additional entry, but entrants are not required to enter another class.

**NOTE:** Stud Dog and Brood Bitch are offered only at the Friday PM show. \$22.00

**FRIDAY SPECIALTY SHOW #1 BREED PRIZES**

CLASS	TROPHY
BOB	Grooming Basket
BOW	Grooming Basket
BOS	Grooming Basket
SD, SB	Bath Towel & Brush
WD	Custom Spray Bottle
WB	Custom Spray Bottle
RWD	Towel
RWB	Towel
First place regular classes	Brush
Best Puppy	Stuffed Animal
AOM#1, AOM #2	Bath Towel & Brush
Veteran First place	Stuffed Animal
Best Veteran	Stuffed Animal

**FRIDAY SPECIALTY SHOW #2 BREED PRIZES**

CLASS	TROPHY
BOB	Custom Dog Bowl and Tumbler
BOW	Tumbler
BOS	Custom Dog Bowl
Select,Winners, Reserve	Tumbler
First place regular classes	Tumbler
Best Puppy, Best Bred by	Tumbler
AOM#1, AOM #2	Tumbler
Stud Dog, Brood Bitch	Tumbler

**SATURDAY SPECIALTY SHOW BREED PRIZES**

CLASS	TROPHY
BOB	Enrichment Puzzle, Lickimat, XL Chuck-It Toy
BOW	Enrichment Puzzle
BOS	Enrichment Puzzle, Lickimat
SD, SB	Lickimat
WD, WB	Snufflemat
RWD, RWB	Interactive Dog Toy
First place regular classes	Lickimat
Best Puppy	Lickimat Puppy Playstation
AOM#1	Lickimat
AOM#2	Lickimat



**POODLE CLUB OF LAS VEGAS  
TWO SPECIALTY SHOWS**

Licensed by the American Kennel Club • Indoors • Unbenched – Limit of 100 entries

**FRIDAY, MARCH 20, 2026**

SHOW HOURS –7:00AM to 5:00PM

Put In Your Browser: [poodlecluboflasvegasnv.com](http://poodlecluboflasvegasnv.com)

Website Gurus: Asia Gomez

**OFFICERS**

President ..... Susie Osburn  
Vice President ..... Laura Alton  
Treasurer ..... David Terrel  
Corresponding Secretary ..... Javier Torres

4162 Pohickery Court Las Vegas, NV 89115

**BOARD OF DIRECTORS**

Erik Lingren, Donna Lewis

**SHOW COMMITTEE**

Michael McAuliffe – Show Chair

2487 E. Hacienda Ave. Las Vegas, NV 89120 [lidopoodles.cox.net](mailto:lidopoodles.cox.net) 702-493-3976

Javier Torres David Terrel Susie Osburn Carol Riback

**COMMITTEES**

Javier Torres ..... Hospitality  
Javier Torres ..... Grounds  
Susie Osburn ..... Ring Stewards  
Donna Lewis & Asia Gomez ..... Raffle Divas  
Members of the PCLV ..... Trophies

**JUDGES**

Ms. Carol Graham ..... 292201 TWP Road 262A  
Show #1 – Regular & Non-Regular Classes ..... Rocky View, AB T4A ON2

Ms. Denise Dean ..... PO Box 50517 Parks, AZ 86018  
Show #2 – Regular & Non-Regular Classes

***NOHS is not offered at these events***

Note: Superintendent, Photographer, Veterinarian, Parking, Classification, Entry Fees, Ribbons, and all rules relating to the grounds for this event will follow the host club

The Poodle Club of Las Vegas, Inc. will have available a New Exhibitor Briefing and Dog Show Tour for those interested. Please see Specialty Chair the morning of the show.

**THERE WILL BE COMPETITION FOR BEST PUPPY IN PUPPY CLASSES, BEST BRED-BY-EXHIBITOR BEST STUD DOG & BEST BROOD BITCH IN BREED IN EACH VARIETY (BOTH SHOWS)**

**PARADE OF TITLEHOLDERS - FIRST SHOW ONLY**

Eligibility: Poodles that are AKC Champions of Record or holders of AKC recognized titles may be entered in the Parade of Titleholders. Poodles entered in the Parade of Titleholders CANNOT be entered in any of the breed classes at this show. Poodles so entered will be presented with a Rosette. Coat Clips must be in accordance with the Breed Standards. Entrants should include with their entry, a resume of their dog's history (up to 50 words) to be read at the time of presentation.

**BREED & VARIETY PRIZES - BOTH SHOWS**

The Poodle Club of Las Vegas, Inc., will retain any unclaimed prizes. Unless otherwise indicated, the following prizes are offered by the Poodle Club of Las Vegas, Inc., through the generosity of members & friends.

The Poodle Club of Las Vegas, Inc. offers a Rosette for the following:

For Breed: Best of Breed, Best of Opposite Sex to Best of Breed, Best Puppy in Puppy Classes, Best Bred-By-Exhibitor, Best Stud Dog & Best Brood Bitch.

For Each Variety: Best of Variety, Best of Winners, Best of Opposite Sex to Best of Variety, Select Dog, Select Bitch, Best Puppy in Puppy Classes, Best Bred-By- Exhibitor, Stud Dog Class, & Brood Bitch Class.

BEST OF BREED - Sterling Silver Medallion offered by the Poodle Club of America, Inc.

BEST OF BREED - Special Rosette with Poodle Club of Las Vegas, Inc. Colors offered by Jan Sutherland.

BEST OF BREED - Fleece Throw with Poodle Club of Las Vegas, Inc. Logo

BEST OF OPPOSITE SEX TO BEST OF BREED - Grooming Apron with Poodle Club of Las Vegas, Inc. Logo

BEST PUPPY IN PUPPY CLASSES - Large Towel

BEST BRED-BY-EXHIBITOR - Large Towel

BEST VETERAN - Large Towel

BEST STUD DOG - Large Towel

BEST BROOD BITCH - Large Towel IN EACH VARIETY

BEST OF VARIETY - Black Towel with Poodle Club of Las Vegas, Inc. Logo

**Memorials on Display - Both Shows**

The Poodle Club of Las Vegas, Inc. will have on display the Betty Osburn Memorial Trophy, to honor Best of Breed. A miniature replica of the Trophy will be awarded to the winner.

A "Completed Title" Rosette will be available for a new championship earned on this day. See Specialty Chair.



**OBEDIENCE TRIAL & RALLY TRIAL**

Licensed by the American Kennel Club •Indoors

**FRIDAY, MARCH 20, 2026**

EVENT HOURS – 7:00AM to 6:00PM

**OFFICERS**

President ..... Daniele Ledoux-Starzyk  
Vice President ..... Susie Osburn  
Treasurer ..... Nancy Swords  
Recording Secretary ..... Kristina Klinger  
Corresponding Secretary ..... Kathy Mondragon  
3545 Starlight Ranch Ave, N Las Vegas NV 89081 [kmondragon96@gmail.com](mailto:kmondragon96@gmail.com)

**BOARD OF DIRECTORS**

Laura Alton – Geri Hunt

**SHOW COMMITTEE**

Geri Hunt - Obedience & Rally Trial Chair

4236 Jadestone Ave., Las Vegas, NV 89108 702-480-1438 [doglover555@yahoo.com](mailto:doglover555@yahoo.com)

Laura Alton - Geri Hunt - Sandy Burns

**COMMITTEE**

Geri Hunt – Chief Ring Steward

Note: Superintendent, Photographer, Veterinarian, Parking, Classification, Entry Fees, Ribbons,  
and all rules relating to the grounds for this event will follow the host club

**JUDGES**

Mr. Terry Lynn Thornton 175 Cedar Crest Rd, Nogal, NM 88341

OBEDIENCE: Graduate Novice, Open A & B, Graduate Open, Preferred Open, Utility A & B,  
Preferred Utility, Versatility

Mr. Kenneth Kozak - 417 SE 46th St, Oklahoma City, OK 73129

OBEDIENCE: Novice A & B, Beginner Novice A & B, Preferred Novice

RALLY: Novice A & B, Intermediate, Advances A & B, Excellent A & B, Master, Choice

### **REGULAR CLASSES**

NOVICE A • NOVICE B • OPEN A • OPEN B • UTILITY A • UTILITY B

### **OPTIONAL TITLING CLASSES**

BEGINNER NOVICE A & B • GRADUATE NOVICE • GRADUATE OPEN • VERSATILITY

### **PREFERRED CLASSES**

PREFERRED NOVICE • PREFERRED OPEN • PREFERRED UTILITY

### **RALLY CLASSES**

NOVICE A • NOVICE B • INTERMEDIATE • ADVANCED A • ADVANCED B EXCELLENT A • EXCELLENT B • MASTER • CHOICE

RALLY RING WILL BE 40'X50'

ALL PRIZES/AWARDS MUST BE CLAIMED PRIOR TO CLOSE OF THE TRIALS. NO PRIZES/AWARDS WILL BE MAILED.

Prizes listed below will be offered by VVDOC at all Trials, in Regular Classes only, unless otherwise noted. A qualifying score is required for all prizes.

Vegas Valley Dog Obedience Club offers a Title Ribbon to any dog completing a title at these trials.

#### **OBEDIENCE TRIAL PRIZES**

Qualifying score required for all prizes in Titling Classes.

A Dark Green Qualifying Ribbon will be given to each dog attaining a Qualifying Score.

Additional Obedience Trial prizes Offered by the Vegas Valley Dog Obedience Club.

HIT HIGHEST SCORING DOG IN REGULAR CLASSES: Rosette and \$40.00.

HC HIGHEST COMBINED SCORE IN OPEN B & UTILITY CLASSES: Rosette and \$40.00

Dog toy to 1<sup>st</sup> Place in all classes

#### **RALLY TRIAL PRIZES**

Qualifying score required for all prizes.

A Dark Green Qualifying Ribbon will be given to each dog attaining a Qualifying Score.

Additional Rally Trial prizes Offered by the Vegas Valley Dog Obedience Club.

HTC HIGHEST SCORING TRIPLE QUALIFYING SCORE: Rosette and \$40.00

HC HIGHEST COMBINED SCORE ADVANCED B & EXCELLENT B CLASSES: Rosette and \$40.00

Dog toy to 1<sup>st</sup> Place in all classes

### **TROPHY FUND**

*We thank all our generous donors who contributed to our Trophy Fund.*

*Without your help, these prizes would not have been possible.*

## GENERAL INFORMATION

THERE WILL BE DOG BATHING FACILITIES IN THE GROOMING AREA

OUTDOOR GROOMING – ON GRASS - FREE

No tenting provided, you must provide your own shade or tenting & weights

No staking allowed

Quiet generators only • Please do not utilize any electrical outlet

For Giant Breeds ex-pens with tops & bottom clipped together outdoors ONLY

Powder dogs outside only

No table grooming at ringside indoors

THESE ARE SELF-CLEANING SHOWS. AN EVENT COMMITTEE HEARING WILL BE CALLED ON ANYONE NOT CLEANING UP AFTER THEIR DOG OR THEIR GROOMING SPACE AND A MINIMUM \$250.00 FINE WILL BE ASSESSED.

### CATALOG ADVERTISING

Full page \$50. Call Toni to confirm availability • 323-679-4121 Send camera-ready advertising copy and photo to: Toni Young at silverstatekc@gmail.com. Payment must accompany ads. Make Checks payable to Silver State Kennel Club - mail to: Toni Young, Treasurer, 3853 Pima Lane, Las Vegas NV 89169

PayPal to silverstatekc@gmail.com or The PayPal portal on the SSKC website silverstatekennelclub.com

DEADLINE FOR CATALOG ADVERTISING IS February 9, 2026

The show site will be available to exhibitors at 7:00AM each day.

Dogs must be removed from the show grounds immediately following Best in Show on Sunday.

No soliciting allowed on show grounds or parking lot.

Please arrange to have a booth with the Vendor Chairman.

No smoking or vaping.

The Club reserves the right to substitute a prize of equal or greater value.

All trophies must be claimed the day of the show - None will be mailed.

Concessions available.

Overnight Parking is on pavement. Bring ground cover.

Day of Show Parking is on paved parking area.

No electricity available. Quiet generators (outside areas only) are permitted.

No indoor dog bathing facilities are provided on the show grounds.

No set-ups allowed in Day of Show Parking areas.

These are self-cleaning shows. An Event Committee Hearing will be called on anyone not cleaning up after their dog or their grooming space and a minimum \$250.00 fine will be assessed.

No retractable leads.

Unloading/Loading area will be available.

Day of Show and Overnight Parking are considered show grounds.

Please be considerate.

Please plan to have one crate per dog exhibited. Do not house multiple dogs in one crate.

Any owners/handlers leaving dogs ringside unattended before or after scheduled time for that breed may be subject to an Event Committee Hearing.

Any owners/handlers leaving dogs unattended in any parked vehicle may be in violation of county ordinances pertaining to animal cruelty. At such time an animal is discovered to be locked in a parked, hot vehicle, any manner used to free the animal will not result in liability to Silver State Kennel Club, its members or any other



entities. Please take action and plan accordingly for all possible weather conditions. An Event Committee Hearing will be called on any violators, a minimum fine of \$250.00 to increase based on severity and suspension from all showing privileges. Length TBD during hearing. Lost and Found will be located at the catalog table.

PLEASE BE CONSIDERATE OF OTHERS AND SHARE THE SPACE. NO STAKING OF POPUPS, ETC ON GRASS AREAS. PLEASE BRING WEIGHTS. BRING GROUND COVER. DUE TO UNEXPECTED WINDS (OPEN AREAS), POPUPS, ETC MUST BE DROPPED WHEN UNOCCUPIED.

“Anyone in violation of a restriction pursuant to AKC rules or policies, or the law can be asked to leave the grounds. If the person fails to leave, the local authorities will be contacted. In addition, if the club believes laws, restrictions, or conditions of release are being violated by an individual’s attendance or participation in AKC events, the local authorities will be contacted immediately as they have the authority of enforcement.”

The AKC is committed to creating a safe and respectful sport environment for all. If you need to talk to someone, or need help, please call 800. 656.HOPE (National Sexual Assault Hotline) or text HOME to 741-741 for free, 24/7, confidential services from trained crisis counselors.

## ALL EVENTS

---

Overnight parking for self-contained motorhomes up to 40'  
and box vans

**RESERVED OVERNIGHT PARKING HOURS:** Thursday, 3:00PM to 10:00PM. Friday morning, 6:00AM to 8:00AM. Friday day, 2:00PM to 10:00PM. Saturday (Box Vans), 6:00AM to 7:00AM. Saturday, after Best in Show to 9:00PM. Sunday, 6:00AM to 7:00AM.

- Parking will be on a first-come basis. Those wishing to park together must arrive together. There will be no saving of spaces.
- All parking will be on pavement. Bring ground cover.
- No overnight parking except in overnight parking area.
- **RV parking** located in lot between parking garage and hotel fee is \$75.00 per day with a minimum of 2 days.
- **Box Vans** located in back fee is \$75.00 per day with a minimum of 2 days.
- No power available.
- Thursday arrivals are \$20.00 extra.
- Fees cover the entire weekend. No reduction for single night parking.
- All spaces are 23 feet wide X 40 feet long.
- Motor homes over 40 feet are an additional \$20.00 per day.
- Tag (Tow) vehicles \$10.00 per day.
- Cannot park extra car next to Box Vans, need to park in day parking area.
- Dogs are not allowed outside overnight.
- No "Set-Ups" are allowed in Day of Show Parking.
- All parking is at your own risk. The club and its management assume no responsibility for fires, theft and loss or damage to any rig or its cargo.
- Overnight/Day of Show parking is a privilege extended by the Silver State Kennel Club. Any arguments, abusive language, or failure to follow the rules and/or instructions of parking officials may cause withdrawal of all parking privileges without refund of fees and possible discipline by the Show Committee.
- No running of generators after 11 PM or before 6 AM each day, quiet time please.
- All vehicles must be self-contained.
- No discharging of gray water or sanitary tank will be allowed.
- Non-reserved parking is an additional \$20.00 per day

**THE USE OF SHAVINGS IS NOT ALLOWED**

**ALL GENERATORS MUST BE EXHAUSTED VERTICALLY**

## ALL EVENTS

---

### RESERVATIONS TO BE PAID IN ADVANCE RV & BOX VAN PARKING - \$75.00

.....

#### PARKING RESERVATION FORM

***Must be received no later than February 22, 2026***

Registered Owner/Name \_\_\_\_\_

Address \_\_\_\_\_ Phone \_\_\_\_\_

City, State & Zip \_\_\_\_\_

Email: \_\_\_\_\_

Reservation Days: THU \_\_\_\_\_ FRI \_\_\_\_\_ SAT \_\_\_\_\_

Length of RV: \_\_\_\_\_ FT      To be Unhooked? Yes   No   SLIDE-OUT: Yes   No

Tag (tow) Vehicle: Yes   No

Vehicle Type: Motor Home, Truck/Trailer, Van, etc. \_\_\_\_\_

Number of Dogs \_\_\_\_\_ Breed(s) \_\_\_\_\_

Make all checks payable to:

Silver State Kennel Club

Mail Parking Form(s) & self-addressed stamped envelope to:

Ron Mattson

461 Dena Drive

Newbury Park, CA 91320

805-231-8408

[foxridgedobe@verizon.net](mailto:foxridgedobe@verizon.net)

There will be a \$35.00 service charge for returned checks

Payments may also be made online via PayPal: [silverstatekc@gmail.com](mailto:silverstatekc@gmail.com)

## Primm Valley Casino Resort RV Parking Waiver of Liability

The undersigned hereby waives, releases and forever discharges The Primadonna Company, LLC, Affinity Interactive, its parents, affiliates, managers, members, agents, attorneys, employees, staff, volunteers, heirs, executors, administrators, representatives, predecessors, successors and assigns (collectively, "Primm Valley Casino Resort") from any claims resulting from physical or personal injury, pain, suffering, illness, disfigurement, temporary or permanent disability, loss or death, and any property damage that may occur caused by fire, theft, vandalism, water or land-related accidents, natural events or any other occurrences or mishaps.

The undersigned acknowledge they are here of their own free will, and entirely at their own risk. The undersigned understands that the injuries or outcomes described above may arise by their own or others' negligence or conditions on the premises or the conditions or their use of amenities offered at the premises or related to travel to and from the premises. Nonetheless, the undersigned assumes all related risks, both known and unknown. Primm Valley Casino Resort is not responsible for errors, omissions, acts or failures to act of any party or entity conducting a specific event or activity. The undersigned fully understands that this is a release of liability and agrees to voluntarily give up or waive any right that they otherwise have to bring legal action against Primm Valley Casino Resort, its affiliates and parent companies and each of their respective owners, members, officers, directors, representatives, agents, employees, volunteers, for any personal injury or property damage whatsoever for negligence on the part of Primm Valley Casino Resort, its agents and employees. This waiver and release of liability shall remain in effect for the duration of my presence at the premises.

I further agree to indemnify, defend and hold harmless Primm Valley Casino Resort, against any and all claims, suits or actions of any kind whatsoever for liability, damages, compensation or otherwise brought by me or anyone on my behalf, including attorney's fees and any related costs.

☐ **Yes, I have read Primm Valley Casino Resort's RV Parking Waiver of Liability carefully. I clearly understand the terms and voluntarily sign this release agreement. I have also discussed this with all persons in my party and they have authorized me to sign this agreement on their behalf.**

Check-In Date	Check-Out Date

Primary Contact Name	Telephone #

_____ Signature	_____ Date
--------------------	---------------

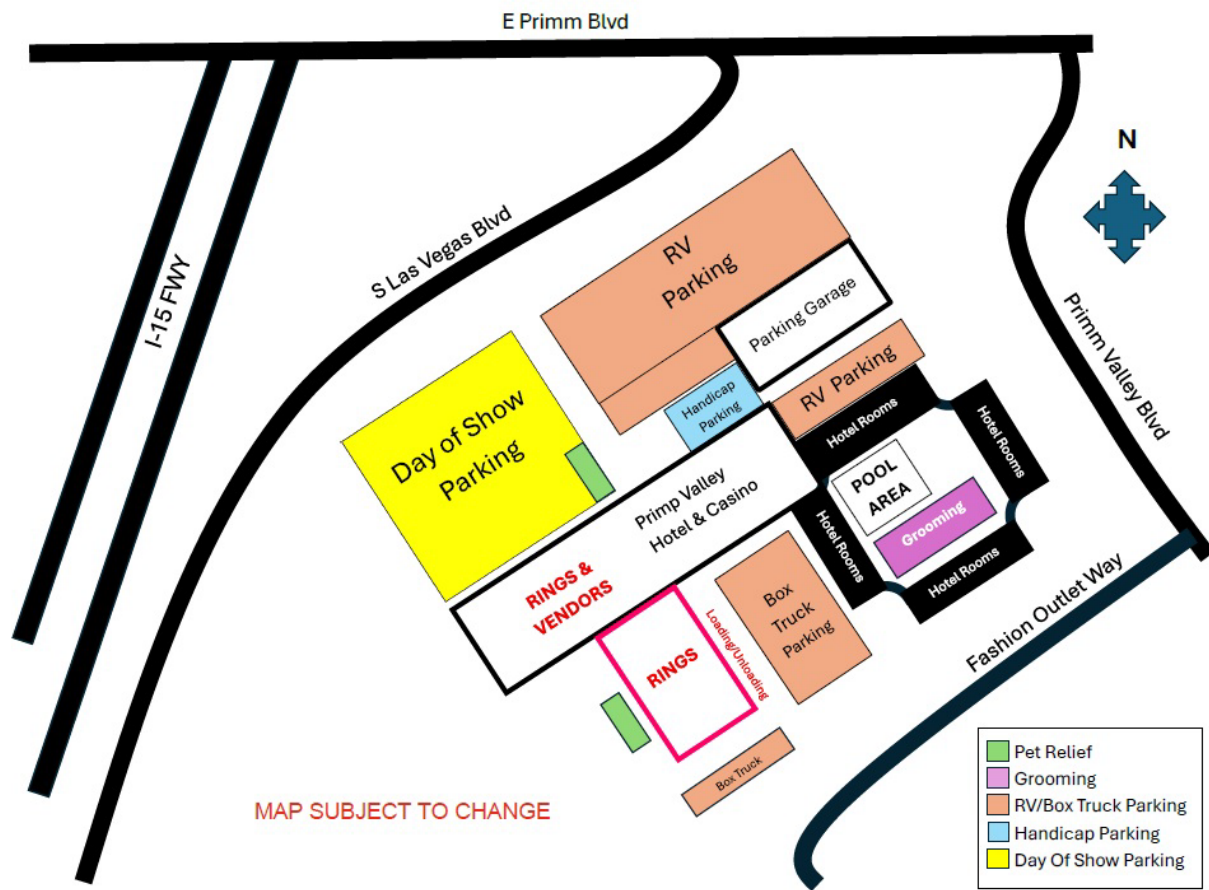

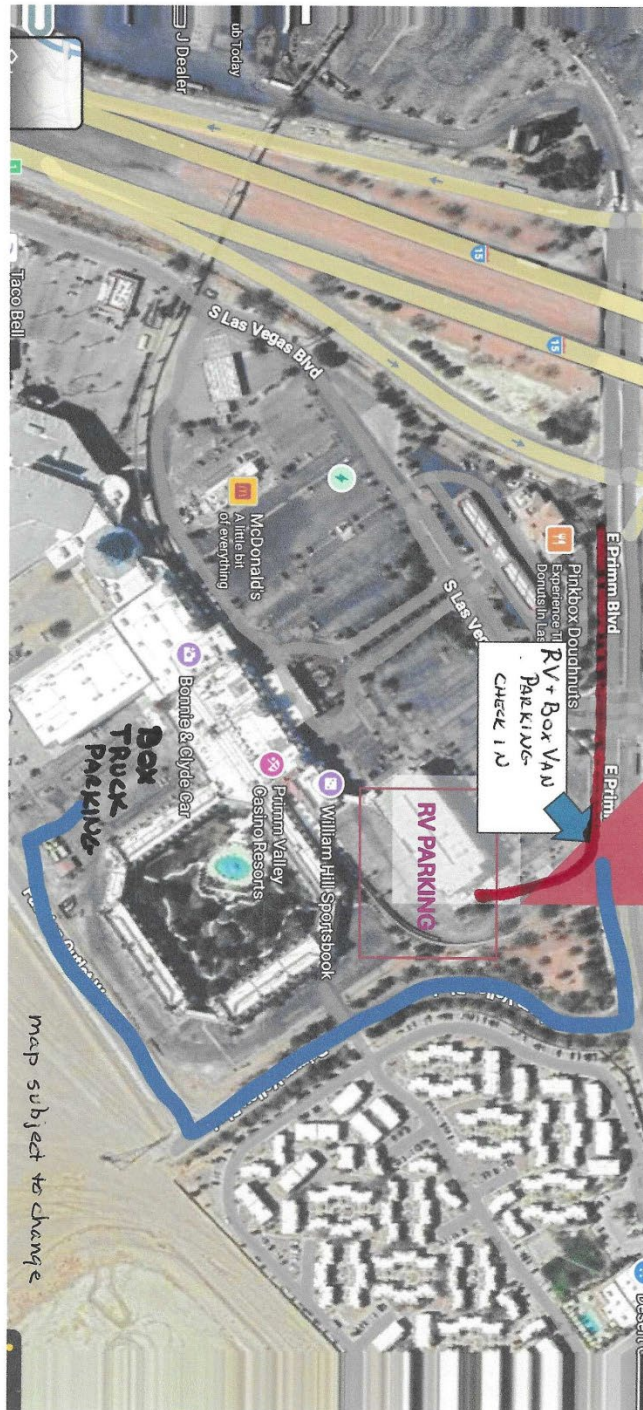

map subject to change

**Primm Valley Resort & Casino**

**31900 Las Vegas Blvd South**

**Primm, NV 89019**

**(702) 386-7867**

[Primm Valley, Buffalo Bill's, Whiskey Pete's Resorts & Casinos \(primmvalleyresorts.com\)](http://primmvalleyresorts.com)

**SILVER STATE KENNEL CLUB**

**PLEASE CALL THE HOTEL DIRECTLY TO BOOK WITH CODE  
SCSILVE BY MARCH 1, 2026**

- Booking Code: SCSILVE
- Call: (702) 386-7867 or 888-PRIMM-NV (888)-774-6668

	Room rate	Resort fee	Pet fee	Tax	Total
Thursday March 19, 2026	\$49.00	\$39.00	1 dog \$20.00	\$13.00	\$121.00
			2 dogs 25.00	14.12	127.12
Friday March 20, 2026	59.00	39.00	20.00	14.75	132.75
			25.00	15.37	138.37
Saturday, March 21, 2026	59.00	39.00	20.00	14.75	132.75
			25.00	15.37	138.37
Sunday, March 22, 2026	49.00	39.00	20.00	13.00	121.00
			25.00	14.12	127.12

Reservations must be made directly with the hotel to receive these rates

Pet charge daily per room - Guests are not to exceed 4 pets

4 dogs? Call in to reserve a room

Free parking   Free High Speed Internet   Food & Drink   Casino & Gambling

**PLEASE CALL THE HOTEL DIRECTLY TO BOOK WITH CODE  
SCSILVE BY MARCH 1, 2026**





**MOBILE VETERINARY SERVICES**

**Dr. Bruce C. Henault**

**Melody Calhoun**

**(702)287-5912**

**[lvpetdocbruski@aol.com](mailto:lvpetdocbruski@aol.com)**

**DOG SHOW- SPECIAL PRICING      (March 20, 21 & 22, 2026)**

**BASIC CARDIAC OFA** **\$195.00**

**INCLUDES - AUSCULTATION, ECHOCARDIOGRAM,  
REPORT WITH MEASUREMENTS AND  
COMPLETED BASIC ECHOCARDIOGRAM  
OFA FORM**

**PATELLA OFA** **\$60.00**

**INCLUDES - STANDARDIZED OFA EVALUATION OF BOTH  
PATELLAS, COMPLETED OFA PATELLA FORM**

**DENTITION OFA** **\$60.00**

**INCLUDES - STANDARDIZED OFA EVALUATION OF  
DENTITION, COMPLETED OFA DENTITION  
FORM**

**ABDOMINAL ULTRASOUND** **\$195.00**

**INCLUDES - FULL ABDOMINAL ULTRASOUND EVALUATION  
WITH FULL WRITTEN REPORT**

**PREGNANCY ULTRASOUND** **\$110.00**

**MULTIPLE OTHER SERVICES AVAILABLE**

**PLEASE REACH OUT BY PHONE, TEXT, OR EMAIL WITH QUESTIONS OR TO SCHEDULE AN APPOINTMENT.**

**CONTACT KAREN KILLOUGH FOR APPOINTMENTS AT [KARENKILLOUGH@GMAIL.COM](mailto:karenlkillough@gmail.com) OR**

**(702)622-6949**

**WE WILL BE AT THE SHOW ALL 3 DAYS, FROM 9AM TO 4PM**

**WE LOOK FORWARD TO SEEING YOU! THANK YOU!**





*International Canine  
Semen Bank - Nevada*



***Preserving your kennel's excellence***

***And continuing the legacy***

**SHOW SPECIAL – 10% OFF**

**PRE-REGISTRATION REQUIRED**

**Collections by appointment only**

Dog's Registered Name: \_\_\_\_\_

Owner \_\_\_\_\_

Address \_\_\_\_\_

City \_\_\_\_\_ State \_\_\_\_\_ Zip Code \_\_\_\_\_

Phone \_\_\_\_\_ Email \_\_\_\_\_

(Please send copy of AKC registration and DNA certificate, if available, with form)

**SCHEDULE OF FEES FOR PROCESSING CANINE SEMEN**

File Preparation (\$65.00), Semen Storage (\$100.00/yr pro-rated),

Semen Collection, Evaluation & Freeze (\$330.00)

**TOTAL BASE FEE \$495.00**

***Call (702) 304-8387 for more information***

**Mail to: Camino Al Norte Animal Hospital**

5130 Camino Al Norte, N. Las Vegas, NV 89031

icsbnevadea@gmail.com



# **Baer Hearing Test \*Show Special\***

***ONLY \$50.00 FOR TESTING DURING THE SHOW!  
THIS IS A SAVINGS OF OVER HALF OFF!!!***

**SATURDAY AND SUNDAY 10:00AM TO 1:00PM  
CALL FOR APPOINTMENT 702-304-8387  
OR SEE US AT THE ICSB TABLE**

## **DIRECTIONS TO THE SHOW**

### **From Northern Nevada: US-95S**

Right onto I-15S ramp  
Exit 1 toward Primm  
Left onto E. Primm Blvd.  
Right onto S. Las Vegas Blvd.  
Left - Left

### **From Arizona: US-95N**

Left onto Nipton Rd. (entering California)  
Right onto I-15N ramp  
Merge onto I-15N (entering Nevada)  
Exit 1 toward Primm  
Right onto E. Primm Blvd.  
Right onto S. Las Vegas Blvd.  
Left – Left

### **From California: I-15 N**

Exit 1 toward Primm  
Right onto E. Primm Blvd.  
Right onto S. Las Vegas Blvd.  
Left – Left

### **From Utah: I-15 S**

Exit 1 toward Primm  
Left onto E. Primm Blvd.  
Right onto S. Las Vegas Blvd.  
Left – Left

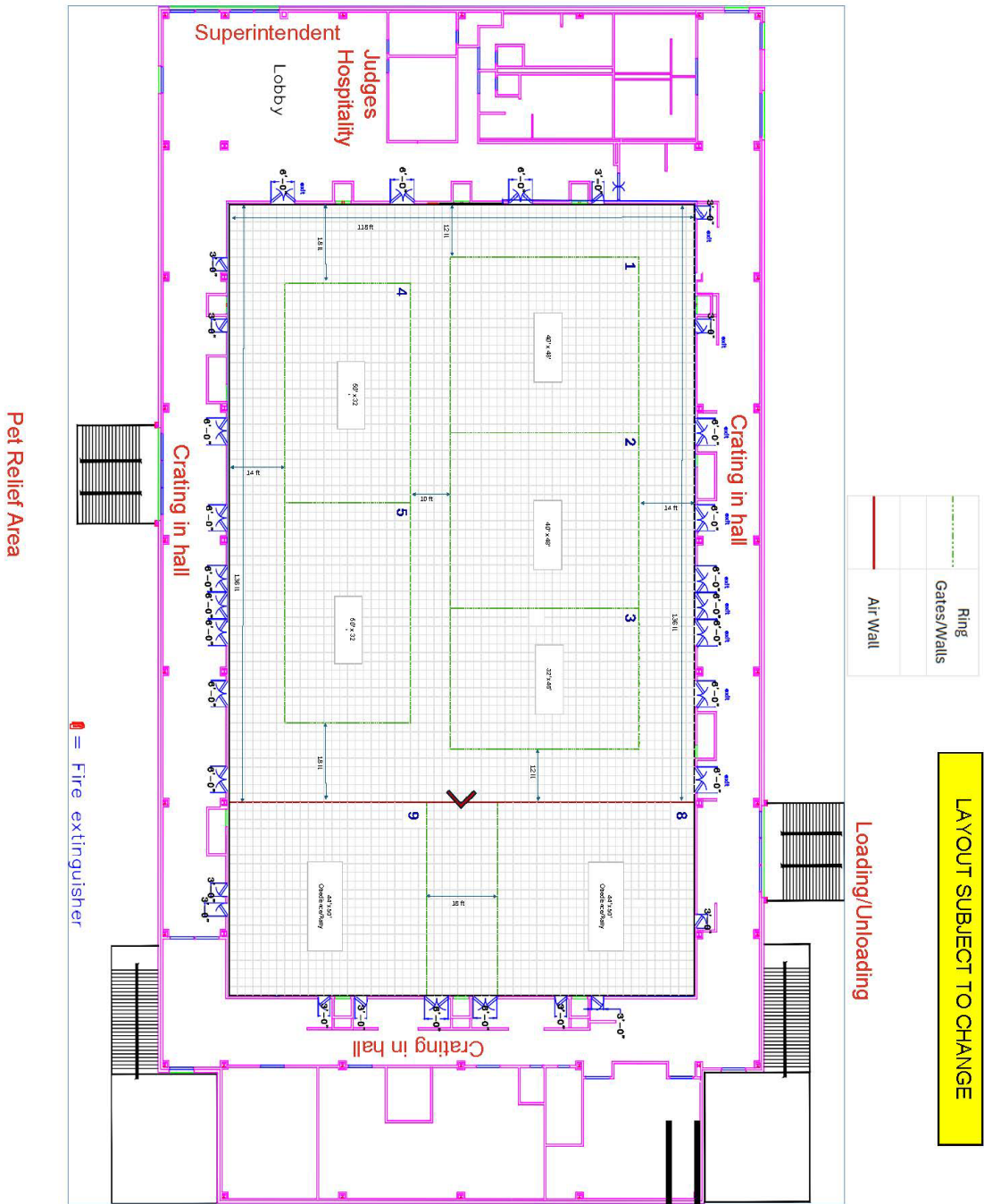



### **ATTENTION EXHIBITORS**

The show site will be available to exhibitors on Friday at 7 am or upon completion of setup of the show grounds. Specialty clubs will have priority over Fri./Sat./ Sun. Exhibitors  
Dogs must be removed from the show grounds one hour after Best in Show on Sunday.

No soliciting allowed on show grounds or parking lot. Please arrange to have a booth with the Vendor Chairman.

No smoking or vaping.

Overnight Parking is on pavement. Bring ground cover. Day of Show Parking is on paved parking area.

No electricity available. Generators (outside areas only) are permitted.

Dog bathing facilities are provided on the show grounds.

No Set-Ups allowed in Day of Show Parking areas.

Ringside crating for ring times only.

No Set-Ups allowed indoors in show building.

Please do not scissor or chalk your dogs on tables next to the indoor rings.

These are self-cleaning shows. A Bench Show Committee will be called on anyone not cleaning up after their dog or their grooming space, and a minimum \$250.00 fine will be assessed

Unloading/Loading area will be available.

Day of Show and Overnight Parking are considered show grounds. Please be considerate.

Please plan to have one crate per dog exhibited. Do not house multiple dogs in one crate.

Any owners/handlers leaving dogs ringside unattended before or after scheduled time for that breed may be subject to a show committee hearing.

Any owners/handlers leaving dogs unattended in any parked vehicle may be in violation of county ordinances pertaining to animal cruelty. At such time an animal is discovered to be locked in a parked, hot vehicle, any manner used to free the animal will **not** result in liability to the club, its members, or any other entities. Please take action and plan accordingly for all possible weather conditions. A show committee hearing will be called on any violators, a minimum \$250.00 fine to increase based on severity, and suspension from all showing privileges. Length TBD during hearing.

Lost and Found will be located at catalog table.

**PLEASE BE CONSIDERATE OF OTHERS AND SHARE THE SPACE NO STAKING OF POPUPS, ETC ON PAVEMENT OR GRASS AREAS. PLEASE BRING WEIGHTS. BRING GROUND COVER. DUE TO UNEXPECTED WINDS (OPEN AREAS), POPUPS, ETC. MUST BE DROPPED WHEN UNOCCUPIED.**





AMERICAN  
KENNEL CLUB

# AKC® Code of Sportsmanship and Civility

**Preface:** The tradition of competitive purebred dog events predates 1884—the year the American Kennel Club (AKC®) was founded. Those involved in these sports share core values, including a strong commitment to sportsmanship and a welcoming, respectful culture that embraces the diverse community united by a love of dogs.

These values are evident across all aspects of the sport: conformation, performance, companion, and family dog activities. Many believe that the enduring principles of sportsmanship and civility are key reasons the sport has thrived for over 140 years.

Recognizing that periodically reaffirming our shared values strengthens our community, the revised code will be shared widely to highlight the foundational values and principles that define the sport.

- Sportspeople always place the welfare of their dog above all else.
- Sportspeople prioritize the long-term health and preservation of their breed, making decisions that reflect a deep commitment to responsible breeding and ownership.
- Sportspeople respect the history, traditions and integrity of the sport of purebred dogs.
- Sportspeople conduct themselves in a manner that reflects positively on the sport, the American Kennel Club, and themselves.
- Sportspeople appreciate, encourage and support all who associate with and participate in the sports by fostering an environment where respect, equity, inclusion, and courtesy are foundational.
- Sportspeople understand, uphold and abide by all AKC bylaws, rules, regulations and policies.
- Sportspeople contribute to a positive atmosphere at events by avoiding negative gossip, disparagement, or unsportsmanlike behavior.
- Sportspeople extend their values of civility, fairness, and respect to all digital and social media platforms.
- Sportspeople actively support the education and mentorship of newcomers, helping them learn the rules, values, and traditions of the sport in a respectful way.
- Sportspeople recognize that they are role models in the sport, and strive to lead by example through humility, kindness, and ethical conduct.
- Sportspeople treat fellow exhibitors, judges, officials, volunteers, spectators, and AKC staff with dignity and respect, regardless of experience, background, or differences in opinion.
- Sportspeople are committed to fair play, honesty, courtesy, and competition, approaching both winning and losing with grace.
- Sportspeople understand that strong competition and civility can—and should—coexist. They appreciate the quality of their competitors, and the effort put forth by others.
- Sportspeople uphold their responsibilities to the sport of purebred dogs and refuse to let personal gain or self-interest influence their decisions or behavior.
- The sportsperson judges only on the merits of the dogs and considers no other factors.
- The sportsperson judge or exhibitor accepts constructive criticism.
- The sportsperson exhibitor declines to enter or exhibit under a judge where it might reasonably appear that the judge's placements could be based on something other than the merits of the dogs.
- The sportsperson exhibitor refuses to compromise the impartiality of a judge.
- Sportspeople are willing to share honest and open appraisals of both the strengths and weaknesses of their breeding stock.
- Sportspeople decline to exploit any positions of authority or recognition for personal advantage.
- Sportspeople appreciate those that have gone before them and realize they are responsible for maintaining and enhancing the sport for future generations.



**Everything We Do,  
We Do for Dogs.**

7/2025

## **RELEASE AND WAIVER OF LIABILITY AND INDEMNITY AGREEMENT**

### **WAIVER & RELEASE FROM LIABILITY:**

In consideration for being permitted to enter, compete, observe, vend, or participate in any way and for any purpose in the "2026 Silver State Kennel Club Event" (the "Event"), or any event related or connected thereto, THE UNDERSIGNED, for himself/herself, his/her personal representatives, heirs, administrators, next of kin, and/or assigns:

1. HEREBY COVENANTS NOT TO SUE, RELEASES, WAIVES, AND DISCHARGES, The Primadonna Company, LLC, d/b/a Primm Valley Casino Resort, a Nevada limited liability company, Affinity Interactive and their past and present directors, officers, employees, subsidiaries, affiliates, sponsors, agents, members, shareholders, representatives, officials, successors and assigns (hereinafter, the "Releasees") from all liability to the undersigned for any and all loss, expense (including attorney's fees), cost, judgment, lien, or damage whatsoever, and any claim or demand arising or relating thereto, on account of injury to the person or property, or resulting in death of the undersigned, whether caused by the negligence of the Releasees or otherwise, while the undersigned is competing, officiating in, observing, working for, or participating in any capacity in the Event; in activities related to or connected with the Event, whether caused by the negligence of the Releasees or otherwise.

2. HEREBY AGREES TO INDEMNIFY AND SAVE AND HOLD HARMLESS the Releasees and each of them from and against any and all claims of third parties, including, but not limited to, fellow employees and members of the public, for any loss, liability, damage, or cost which may result from or be caused by the undersigned's own willful misconduct or negligent conduct during the Event, or that they may incur due to the presence of the undersigned in the Event, or to the undersigned's competing, officiating, observing, working for, or participating in any way, for any purpose, in activities related to or connected with the Event, whether caused by the negligence of the Releasees or otherwise. This indemnity shall survive the undersigned's participation in the Event; and

3. HEREBY ASSUMES FULL RESPONSIBILITY FOR AND RISK OF BODILY INJURY, DEATH, OR PROPERTY DAMAGE due to the presence of the undersigned in the Event, or to the undersigned's competing, officiating, observing, working for, or participating in any way, for any purpose, in activities related to or connected with the Event, whether caused by the negligence of the Releasees or otherwise.

THE UNDERSIGNED states that his/her attendance and participation in the Event is strictly voluntary and without compensation, that he/she has been apprised of and fully comprehends the risks and dangers associated and involved with participation in the Event, and that he/she assumes all risk of injury to his/her person and property that may be sustained in connection with or as a result of participation in the Event. Further,

THE UNDERSIGNED expressly acknowledges and agrees that some activities related to the Event may involve some risk or danger, including serious injury, death, and/or property damage.

THE UNDERSIGNED agrees expressly that this release, waiver, and indemnity agreement is intended to be as broad and inclusive as is permitted by the laws of Nevada and that if any portion thereof is held invalid, it is agreed that the balance shall, notwithstanding, continue in full legal force and effect.

THE UNDERSIGNED HAS READ AND VOLUNTARILY SIGNS THIS RELEASE AND WAIVER OF LIABILITY AND INDEMNITY AGREEMENT, and further agrees that no oral representations, statements or inducement apart from the forgoing written agreement have been made.

THE UNDERSIGNED, if a vendor with a van or box truck, represents and warrants that they have automobile insurance as required by and that is fully in compliance with Nevada law.

THE UNDERSIGNED, if a volunteer for the Event, understands that he/she is a volunteer and will not be covered under The Primadonna Company, LLC's or Affinity Interactive's worker's compensation policy pursuant to NRS 616A.110(9)(c).

Name: \_\_\_\_\_ Signature: \_\_\_\_\_ Date: \_\_\_\_\_

Address: \_\_\_\_\_

City, State, & Zip: \_\_\_\_\_

E-mail: \_\_\_\_\_ Phone#: \_\_\_\_\_

# FSS OPEN SHOWS

**2 Events held each day**

**Saturday, Sunday**

**FSS OPEN SHOW JUDGES**

Silver State Kennel Club

Saturday event numbers 2026018308, First Judge Mrs. Danelle M. Brown

2026018309, Second Judge Ms. Denise Dean

Sunday event numbers 2026018310, First Judge Mr. Dave Peat

2026018311 Second Judge Mr. Ronald Freeman

The following breed classes will be offered at all FSS Open Shows: 4 – 6 Month, 6 – 9 Month, 9 – 12 Month, Bred By Exhibitor, Open

## FSS OPEN SHOWS

### RIBBON PRIZES

The following ribbon prizes will be awarded in the classes:

First Prize – **Rose Ribbon**

Third Prize – **Light Green Ribbon**

Second Prize – **Brown Ribbon**

Fourth Prize – **Gray Ribbon**

Best of Breed – **Orange Ribbon**

Best of Opposite Sex to Best of Breed – **Lavender Ribbon**

Best FSS, Best Miscellaneous, Best in Open Show – **Pink and Green Rosette**

## The Silver State Kennel Club offers the following rosettes

**Both FSS and Miscellaneous group placement First, Second Third, Fourth**

**Both Best FSS and Best Miscellaneous**

**First in FSS group = Best FSS**

**First in Miscellaneous group = Best Miscellaneous**

**Best In Open Show**



**FSS Open – Best in Show - Large Bag of Food**

*Food Prizes will be shipped to the winners*

## WHO CAN PARTICIPATE?

FSS and Miscellaneous breeds, ages 4 months and older on the day of the event, are eligible to compete and earn points towards the Certificate of Merit. Approved parent clubs for Miscellaneous Class and FSS breeds may offer classes for all Miscellaneous & FSS breeds or for their breed only!

**Entry \$36 per event**

### Progression of judging:

Entries will be judged 1<sup>st</sup>-4<sup>th</sup> in their class (divided by sex)

Best of Breed and Best Opposite Sex within each breed

a. FSS best of breed winners compete for 4 group placements. Best in FSS. Best FSS is the same as Group 1.

b. Miscellaneous best of breed winners compete for 4 group placements. Best In Miscellaneous is the same as Group 1.

Best in FSS and Best in Miscellaneous groups are held with group placements awarded.

Best in FSS and Best in Miscellaneous compete for Best in Open Show..



## Silver State Kennel Club

**FSS OPEN SHOWS**

<input type="checkbox"/>	Saturday, March 21, 2026, First
<input type="checkbox"/>	Saturday, March 21, 2026, Second
<input type="checkbox"/>	Sunday, March 22, 2026, First
<input type="checkbox"/>	Sunday, March 22, 2026, Second

**PRIMM VALLEY RESORT & CASINO**  
**31900 S Las Vegas Blvd, Primm, NV 89019**

MAIL ENTRIES WITH FEES TO: JACK BRADSHAW, 320 Maple Avenue, Torrance, CA 90503  
 MAKE CHECKS payable to JACK BRADSHAW. FAX (323) 727-2949; website: www.jbradshaw.com  
 ENTRIES must be received by the Superintendent not later than **NOON, Wed., March 4, 2026 PST**

***Open to Miscellaneous Class and all FSS breeds only***

FIRST ENTRY of a dog at each show **\$36.00.**

Classes will be offered at all Open Shows: 4-6 Month, 6-9 Month, 9-12 Month, Bred by Exhibitor, Open  
 ENTRY MUST BE SIGNED at the bottom by the owner or owner's duly authorized agent, otherwise entry  
 cannot be accepted. I ENCLOSE \$\_\_\_\_\_ for entry fees.

BREED		VARIETY 1		SEX
DOG <sup>2</sup> <sub>3</sub> SHOW CLASS		CLASS <sup>3</sup> DIVISION Weight, color, etc.		
ADDITIONAL CLASSES	OBEDIENCE CLASS (Jump Height)	RALLY CLASS (Jump Height)	JR. SHOWMANSHIP CLASS	
NAME OF (See Back) JUNIOR HANDLER (if any)				JR. HANDLER NUMBER
FULL NAME OF DOG				
<input type="checkbox"/> AKC® NO. <input type="checkbox"/> PAL NO. <input type="checkbox"/> FOREIGN REG NO & COUNTRY		Enter number here DATE OF BIRTH PLACE OF BIRTH (list country) Do not print the above in the catalog.		
BREEDER				
SIRE				
DAM				
ACTUAL OWNER(S) _____ <small>4 (Please Print)</small> OWNER'S ADDRESS _____ CITY _____ STATE _____ ZIP _____				
NAME OF OWNER'S AGENT (IF ANY) AT THE SHOW _____				

I CERTIFY that I am the actual owner of the dog, or that I am the duly authorized agent of the actual owner whose name I have entered above. In consideration of the acceptance of this entry, I (we) agree to abide by the rules and regulations of the American Kennel Club in effect at the time of this event, and by any additional rules and regulations appearing in the premium list for this event, and further agree to be bound by the "Agreement" printed on the reverse side of this entry form. I (we) certify and represent that the dog entered is not a hazard to persons or other dogs. This entry is submitted for acceptance on the foregoing representation and Agreement. I (we) agree to conduct myself (ourselves) in accordance with all such Rules and Regulations (including all provisions applying to discipline) and to abide by any decisions made in accord with them.

**Signature** of owner or his agent  
 duly authorized to make this entry:

Daytime  
 Telephone

Email

### **AGREEMENT**

I (we) agree that the club holding this event has the right to refuse this entry for cause which the club shall deem sufficient. In consideration of the acceptance of this entry and of the holding of this event and of the opportunity to have the dog judged and to win prizes, ribbons, or trophies, I (we) agree to hold the AKC, the event-giving club, their members, directors, governors, officers, agents, superintendents or event secretary and the owner and/or lessor of the premises and any provider of services that are necessary to hold this event and any employees or volunteers of the aforementioned parties, and any AKC approved judge, judging at this event, harmless from any claim for loss or injury which may be alleged to have been caused directly or indirectly to any person or thing by the act of this dog while in or about the event premises or grounds or near any entrance thereto, and I (we) personally assume all responsibility and liability for any such claim; and I (we) further agree to hold the aforementioned parties harmless from any claim for loss, injury or damage to this dog.

Additionally, I (we) hereby assume the sole responsibility for and agree to indemnify, defend and save the aforementioned parties harmless from any and all loss and expense (including legal fees) by reason of the liability imposed by law upon any of the aforementioned parties for damage because of bodily injuries, including death at any time resulting therefrom, sustained by any person or persons, including myself (ourselves), or on account of damage to property, arising out of or in consequence of my (our) participation in this event, however such, injuries, death or property damage may be caused, and whether or not the same may have been caused or may be alleged to have been caused by the negligence of the aforementioned parties or any of their employees, agents, or any other persons.

**I (WE) AGREE THAT ANY CAUSE OF ACTION, CONTROVERSY OR CLAIM ARISING OUT OF OR RELATED TO THE ENTRY, EXHIBITION OR ATTENDANCE AT THE EVENT BETWEEN THE AKC AND THE EVENT-GIVING CLUB (UNLESS OTHERWISE STATED IN ITS PREMIUM LIST) AND MYSELF (OURSELVES) OR AS TO THE CONSTRUCTION, INTERPRETATION AND EFFECT OF THIS AGREEMENT SHALL BE SETTLED BY ARBITRATION PURSUANT TO THE APPLICABLE RULES OF THE AMERICAN ARBITRATION ASSOCIATION. HOWEVER, PRIOR TO ARBITRATION ALL APPLICABLE AKC BYLAWS, RULES, REGULATIONS AND PROCEDURES MUST FIRST BE FOLLOWED AS SET FORTH IN THE AKC CHARTER AND BYLAWS, RULES, REGULATIONS, PUBLISHED POLICIES AND GUIDELINES. 1/1/19**



Please visit

<https://www.instagram.com/jackbradshawdogshows/>

for new information, updates, weather conditions, exhibitor information, etc."

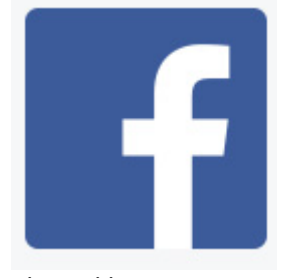

Please like our page at

<https://www.facebook.com/JackBradshawDogShows>

for new information, updates, weather conditions, exhibitor information, etc."

## ADDITIONAL RULES

1. Entries must reach the Superintendent, Jack Bradshaw, 320 Maple Avenue, Torrance, CA 90503, by Noon, Wednesday March 4, 2026 PT. Fees should accompany entries. This club and/or its superintendent assume no responsibility for wrong or incomplete information given on the entry blank by the owner or agent of the owner. This club and its superintendents assume no responsibility for the owner or owner's agents entering a dog in a class in which the dog is not eligible to compete, or for entering the same dog twice.
2. Returned Checks do not constitute a valid entry fee. The Superintendent will add a collection fee to the amount of each returned check and declined credit card. Subsequent returned checks for the same exhibitors may result in their being put on a CASH ONLY basis. The returned check or declined credit card MUST BE MADE GOOD by cash or money order BEFORE the dog will be allowed in the ring.
3. Exhibitors' Identification tickets and judging programs will be e- mailed to the address given on the entry blank. If not received within a reasonable time prior to the show, notify the superintendent.
4. During the hours of judging owners or their handlers are to be on call and have their dogs ready to bring into the judging ring promptly, in order that the judging will not be delayed. Dogs need only be present for their judging. Dogs not needed for further judging may be excused. It is the responsibility of the exhibitor to have his dog ready to be shown and at the entrance of the judging ring when the steward calls for the class. Owners of dogs or the handlers of the dogs alone are responsible for the presence of their dogs in the judging rings. This means it is not the responsibility of the ring steward, nor of any agent of the show-giving club to locate any dog, its owner or handler, when the dog's presence is needed in a judging ring. It should be understood by every exhibitor and handler that waiting for dogs to be brought into the ring is a courtesy extended to the owner or handler of the dog. There is no rule of this club nor of The American Kennel Club that requires a judge to wait for an owner or handler to bring his dog into the ring. Show hours are 7:00 a.m. to 6:00 p.m.
5. Trophies and prizes will be awarded in the judging ring before the completion of the judging of the breed and the superintendent's office advised at once, in the event of any discrepancy. All trophies must be claimed on the day of the show. None will be mailed.
6. Exhibitors are admonished to make themselves familiar with the agreement of the American Kennel Club, referred to on the reverse side of the entry blanks that accompany this premium list. Rulebooks are available online at [www.akc.org](http://www.akc.org)
7. The club, its superintendents or their employees will not be responsible for the loss of or damage to any dog exhibited, whether the result of accident or other causes and in addition assumes no responsibility for any loss, damage or injury sustained by an exhibitor or handler. It is distinctly understood that every dog at this show is in the care and custody and control of his owner or handler during the entire time the dog is on the show premises.
8. Entry fees shall NOT be refunded in the event that a dog is absent, disqualified, sick, lame, excused by veterinarian or judge, barred from competition by action of the Bench Show Committee, or because the dog is ineligible to compete due to being entered incorrectly. There is no refund of entry fee for duplicate entry. There will be a \$4.00 fee charged for cancellation of entry prior to closing of entries.
9. Declination of Entries. The club may decline any entries for cause and may refuse to receive or may remove any dog on account of disease, viciousness or other causes, and no one shall have any claim or recourse against the Kennel Club or any official thereof.
10. If, because of riots, civil disturbances or other acts beyond the control of the management, it is impossible to open or complete the show, no refund of entry will be made.
11. Do not leave any dogs in closed vehicles.
12. Junior Handlers who win a third Novice Class after the Closing of entries for a show may transfer their entry from the Novice Class to the Open Class provided that this transfer is made by the Superintendent at least one half-hour prior to the scheduled start of Junior Showmanship.
13. Dogs which according to their owners' records have earned an obedience or rally title after the closing of entries for the show may be moved up to the next class, provided this transfer is made in writing and presented to the superintendent at least 30 minutes prior to the start of each trial.
14. Parents and/or guardians are responsible for the actions of their children.
15. Bitches in season are ineligible to compete in trials. To receive a refund, a veterinarian's letter needs to be received by the Superintendent no later than one half hour prior to the start of the first class in the trial. There will be a \$4.00 fee charged for bitch in season cancellations.
16. Exhibitors will be held liable for any damages either intentional or unintentional by Primm Valley Resort & Casino and the club.
17. Self-cleaning grounds. A show committee will be called on anyone not cleaning up after their dogs and themselves. No cigarette butts on grounds.
18. Anyone in violation of a restriction pursuant to AKC rules or policies, or the law can be asked to leave the grounds. If the person fails to leave, the local authorities will be contacted. In addition, if the club believes laws, restrictions, or conditions of release are being violated by an individual's attendance or participation in AKC events, the local authorities will be contacted immediately as they have the authority of enforcement.
19. The AKC is committed to creating a safe and respectful sport environment for all. If you need to talk to someone, or need help, please call 800.656.HOPE (National Sexual Assault Hotline) or text HOME to 741-741 for free, 24/7, confidential services from trained crisis counselors.

## 4-6 Month Beginner Puppy Event

**Silver State Kennel Club**  
**Saturday, March 21, 2026**

**Judge**  
**Marissa Clark**

### **Regulations Section 1- Classifications**

The Four-to-Six Month Puppy competition shall be for dogs that are four months of age and over but under six months on the day of the event. Classes will be offered for breeds and varieties and divided into Groups as described in Chapter 3, Section 1 of the *Rules Applying to Dog Shows* and the Miscellaneous Class breeds as listed in Chapter 3, Section 23. The Miscellaneous class competition will be the equivalent of Group competition and the winner will be eligible to compete in Best Four-to-Six Month Puppy in Show. The FSS competition will be the equivalent of Group competition and the winner will be eligible to compete in Best Four-to-Six Month Puppy in Show.

### **Section 2 – Entry and Eligibility**

Entry and eligibility requirements include:

- The Four-to-Six Month Puppy event may be offered at licensed or member dog shows at the option of the show giving club.
- Four-to-Six Month Puppy Competition must be listed in the premium list, entry form and judging schedule, if offered.
- Closing date and time for this competition may be listed as any date and time prior to the event including the same day as the event and must be listed in the premium list, entry form and judging schedule.
- AKC registration number or an AKC litter number will be required for entries of an AKC recognized
- breed as listed in Chapter 3, Section 1 of the *Rules Applying to Dog Shows*.
- A foreign born dog may enter this class if they are registered in the country of origin.
- FSS number or FSS registered litter number will be required for Miscellaneous and FSS breed entries.
- All entrants are to be vaccinated (including rabies) in accordance with their veterinarian's protocol.
- Dogs that are owned or co-owned by a professional handler may compete in this class, but must be handled by a non-professional handler. *Professional handlers are defined as any person who belongs or has belonged to a professional handlers' organization, distributed rate cards, or otherwise advertised or represented themselves as handling dogs for pay within the last five years. Dogs may not be exhibited by current assistants and household members of a professional handler.*

Ribbons for Groups and Best Four to Six Puppy in Show will be as follows:

Best of Breed – Orange; Best of Opposite Sex – Lavender;

Best 4-6 Month Puppy in Show – Pink & Green

**4-6 Month Beginner Puppy Event****Silver State Kennel Club Saturday, March 21, 2026****PRIMM VALLEY RESORT & CASINO****31900 S Las Vegas Blvd, Primm, NV 89019**

MAIL ENTRIES WITH FEES TO: JACK BRADSHAW., 320 Maple Avenue, Torrance, CA 90503

MAKE CHECKS payable to JACK BRADSHAW. FAX (323) 727-2949 e-Mail Entries: www.jbradshaw.com

ENTRIES must be received by the Superintendent not later than **NOON, WED., MARCH 4, 2026 PST**4-6 Month Beginner Puppy **\$20.00**

ENTRY MUST BE SIGNED at the bottom by the owner or owner's duly authorized agent, otherwise entry cannot be accepted. I enclose \$ \_\_\_\_\_ for entry fees.

BREED		VARIETY 1		SEX
DOG 2 3 SHOW CLASS		CLASS 3 DIVISION Weight, color, etc.		
ADDITIONAL CLASSES	OBEDIENCE CLASS (Jump Height)	RALLY CLASS (Jump Height)	JR. SHOWMANSHIP CLASS	
NAME OF (See Back) JUNIOR HANDLER (if any)				JR. HANDLER NUMBER
FULL NAME OF DOG				
<input type="checkbox"/> AKC® NO. <input type="checkbox"/> PAL NO. <input type="checkbox"/> FOREIGN REG NO & COUNTRY		Enter number here DATE OF BIRTH PLACE OF BIRTH (list country) Do not print the above in the catalog.		
BREEDER				
SIRE				
DAM				
ACTUAL OWNER(S) _____ 4 (Please Print) OWNER'S ADDRESS _____ CITY _____ STATE _____ ZIP _____				
NAME OF OWNER'S AGENT (IF ANY) AT THE SHOW _____				

I CERTIFY that I am the actual owner of the dog, or that I am the duly authorized agent of the actual owner whose name I have entered above. In consideration of the acceptance of this entry, I (we) agree to abide by the rules and regulations of the American Kennel Club in effect at the time of this event, and by any additional rules and regulations appearing in the premium list for this event, and further agree to be bound by the "Agreement" printed on the reverse side of this entry form. I (we) certify and represent that the dog entered is not a hazard to persons or other dogs. This entry is submitted for acceptance on the foregoing representation and Agreement. I (we) agree to conduct myself (ourselves) in accordance with all such Rules and Regulations (including all provisions applying to discipline) and to abide by any decisions made in accord with them.

**Signature** of owner or his agent duly authorized to make this entry: \_\_\_\_\_

Daytime

Telephone

Email

AKC Rules, Regulations, Policies and Guidelines are available on the American Kennel Club Web site, [www.akc.org](http://www.akc.org)

### **AGREEMENT**

I (we) agree that the club holding this event has the right to refuse this entry for cause which the club shall deem sufficient. In consideration of the acceptance of this entry and of the holding of this event and of the opportunity to have the dog judged and to win prizes, ribbons, or trophies, I (we) agree to hold the AKC, the event-giving club, their members, directors, governors, officers, agents, superintendents or event secretary and the owner and/or lessor of the premises and any provider of services that are necessary to hold this event and any employees or volunteers of the aforementioned parties, and any AKC approved judge, judging at this event, harmless from any claim for loss or injury which may be alleged to have been caused directly or indirectly to any person or thing by the act of this dog while in or about the event premises or grounds or near any entrance thereto, and I (we) personally assume all responsibility and liability for any such claim; and I (we) further agree to hold the aforementioned parties harmless from any claim for loss, injury or damage to this dog.

Additionally, I (we) hereby assume the sole responsibility for and agree to indemnify, defend and save the aforementioned parties harmless from any and all loss and expense (including legal fees) by reason of the liability imposed by law upon any of the aforementioned parties for damage because of bodily injuries, including death at any time resulting therefrom, sustained by any person or persons, including myself (ourselves), or on account of damage to property, arising out of or in consequence of my (our) participation in this event, however such, injuries, death or property damage may be caused, and whether or not the same may have been caused or may be alleged to have been caused by the negligence of the aforementioned parties or any of their employees, agents, or any other persons.

**I (WE) AGREE THAT ANY CAUSE OF ACTION, CONTROVERSY OR CLAIM ARISING OUT OF OR RELATED TO THE ENTRY, EXHIBITION OR ATTENDANCE AT THE EVENT BETWEEN THE AKC AND THE EVENT-GIVING CLUB (UNLESS OTHERWISE STATED IN ITS PREMIUM LIST) AND MYSELF (OURSELVES) OR AS TO THE CONSTRUCTION, INTERPRETATION AND EFFECT OF THIS AGREEMENT SHALL BE SETTLED BY ARBITRATION PURSUANT TO THE APPLICABLE RULES OF THE AMERICAN ARBITRATION ASSOCIATION. HOWEVER, PRIOR TO ARBITRATION ALL APPLICABLE AKC BYLAWS, RULES, REGULATIONS AND PROCEDURES MUST FIRST BE FOLLOWED AS SET FORTH IN THE AKC CHARTER AND BYLAWS, RULES, REGULATIONS, PUBLISHED POLICIES AND GUIDELINES. 1/1/19**



Please visit

<https://www.instagram.com/jackbradshawdogshows/>

for new information, updates, weather conditions, exhibitor information, etc."



Please like our page at

<https://www.facebook.com/JackBradshawDogShows>

for new information, updates, weather conditions, exhibitor information, etc."

OFFICIAL AMERICAN KENNEL CLUB ENTRY FORM

- ☐ **Vegas Valley Obedience Club, Friday, March 20, 2026**
- ☐ **Golden Retriever Club of Southern Nevada, Friday, March 20, 2026**
- ☐ **# 1 Poodle Club of Las Vegas, Friday, March 20, 2026**
- ☐ **# 2 Poodle Club of Las Vegas, Friday, March 20, 2026**
- ☐ **# 1 Great Dane Club of Las Vegas, Friday, March 20, 2026**
- ☐ **# 2 Great Dane Club of Las Vegas, Friday, March 20, 2026**
- ☐ **# 3 Great Dane Club of Las Vegas, Saturday, March 21, 2026**

**PRIMM VALLEY RESORT & CASINO 31900 S Las Vegas Blvd, Primm, NV 89019**

MAIL ENTRIES WITH FEES TO: JACK BRADSHAW, 320 Maple Avenue, Torrance, CA 90503.

MAKE CHECKS payable to JACK BRADSHAW FAX (323) 727-2949; website: www.jbradshaw.com.

ENTRIES must be received by the Superintendent not later than **NOON, Wednesday, Mar 4, 2026 PST**

FIRST ENTRY of a dog at each show **\$36.00**, Additional Class **\$30.00**, Bred by **\$25.00**, Jr Show Free.

Great Dane Friday # 1 Show Sweeps \$18.00; Friday # 1 Show Parade \$10.00;

Friday # 2 Show Titleholders \$10.00; Great Dane Friday # 2 Stud Dog or Brood Bitch \$22.00

Poodle Friday # 1 Show Parade \$14.00; Poodle Friday Stud Dog, Brood Bitch \$22.00

ENTRY MUST BE SIGNED at the bottom by the owner or owner's duly authorized agent, otherwise entry cannot be accepted. I ENCLOSE \$\_\_\_\_\_ for entry fees.

BREED		VARIETY 1		SEX	
DOG 2 3 SHOW CLASS			CLASS 3 DIVISION <small>Weight, color, etc.</small>		
ADDITIONAL CLASSES		OBEDIENCE CLASS (Jump Height)		RALLY CLASS (Jump Height)	
				JR. SHOWMANSHIP CLASS	
NAME OF (See Back) JUNIOR HANDLER (if any)					JR. HANDLER NUMBER
FULL NAME OF DOG					
<input type="checkbox"/> AKC® NO. <input type="checkbox"/> PAL NO. <input type="checkbox"/> FOREIGN REG NO & COUNTRY			Enter number here DATE OF BIRTH		
			PLACE OF BIRTH (list country) <small>Do not print the above in the catalog.</small>		
BREEDER					
SIRE					
DAM					
<div style="border: 1px solid black; padding: 5px;">           ACTUAL OWNER(S) _____  <small>4 (Please Print)</small>            OWNER'S ADDRESS _____            CITY _____ STATE _____ ZIP _____         </div>					

NAME OF OWNER'S AGENT  
(IF ANY) AT THE SHOW \_\_\_\_\_

I CERTIFY that I am the actual owner of the dog, or that I am the duly authorized agent of the actual owner whose name I have entered above. In consideration of the acceptance of this entry, I (we) agree to abide by the rules and regulations of the American Kennel Club in effect at the time of this event, and by any additional rules and regulations appearing in the premium list for this event, and further agree to be bound by the "Agreement" printed on the reverse side of this entry form. I (we) certify and represent that the dog entered is not a hazard to persons or other dogs. This entry is submitted for acceptance on the foregoing representation and Agreement. I (we) agree to conduct myself (ourselves) in accordance with all such Rules and Regulations (including all provisions applying to discipline) and to abide by any decisions made in accord with them.

**Signature** of owner or his agent duly authorized to make this entry: \_\_\_\_\_

Daytime

Telephone

Email

Owner/Handler Eligible? Yes ☐

No ☐

Emergency Contact \_\_\_\_\_ Phone \_\_\_\_\_

AKC Rules, Regulations, Policies and Guidelines are available on the American Kennel Club Web site, [www.akc.org](http://www.akc.org)

### **AGREEMENT**

I (we) agree that the club holding this event has the right to refuse this entry for cause which the club shall deem sufficient. In consideration of the acceptance of this entry and of the holding of this event and of the opportunity to have the dog judged and to win prizes, ribbons, or trophies, I (we) agree to hold the AKC, the event-giving club, their members, directors, governors, officers, agents, superintendents or event secretary and the owner and/or lessor of the premises and any provider of services that are necessary to hold this event and any employees or volunteers of the aforementioned parties, and any AKC approved judge, judging at this event, harmless from any claim for loss or injury which may be alleged to have been caused directly or indirectly to any person or thing by the act of this dog while in or about the event premises or grounds or near any entrance thereto, and I (we) personally assume all responsibility and liability for any such claim; and I (we) further agree to hold the aforementioned parties harmless from any claim for loss, injury or damage to this dog.

Additionally, I (we) hereby assume the sole responsibility for and agree to indemnify, defend and save the aforementioned parties harmless from any and all loss and expense (including legal fees) by reason of the liability imposed by law upon any of the aforementioned parties for damage because of bodily injuries, including death at any time resulting therefrom, sustained by any person or persons, including myself (ourselves), or on account of damage to property, arising out of or in consequence of my (our) participation in this event, however such, injuries, death or property damage may be caused, and whether or not the same may have been caused or may be alleged to have been caused by the negligence of the aforementioned parties or any of their employees, agents, or any other persons.

**I (WE) AGREE THAT ANY CAUSE OF ACTION, CONTROVERSY OR CLAIM ARISING OUT OF OR RELATED TO THE ENTRY, EXHIBITION OR ATTENDANCE AT THE EVENT BETWEEN THE AKC AND THE EVENT-GIVING CLUB (UNLESS OTHERWISE STATED IN ITS PREMIUM LIST) AND MYSELF (OURSELVES) OR AS TO THE CONSTRUCTION, INTERPRETATION AND EFFECT OF THIS AGREEMENT SHALL BE SETTLED BY ARBITRATION PURSUANT TO THE APPLICABLE RULES OF THE AMERICAN ARBITRATION ASSOCIATION. HOWEVER, PRIOR TO ARBITRATION ALL APPLICABLE AKC BYLAWS, RULES, REGULATIONS AND PROCEDURES MUST FIRST BE FOLLOWED AS SET FORTH IN THE AKC CHARTER AND BYLAWS, RULES, REGULATIONS, PUBLISHED POLICIES AND GUIDELINES. 1/1/19**



Please visit

<https://www.instagram.com/jackbradshawdogshows/>

for new information, updates, weather conditions, exhibitor information, etc."



Please like our page at

<https://www.facebook.com/JackBradshawDogShows>

for new information, updates, weather conditions, exhibitor information, etc."



OFFICIAL AMERICAN KENNEL CLUB ENTRY FORM

☐ **Silver State Kennel Club, Saturday, March 21, 2026**

☐ **Silver State Kennel Club, Sunday, March 22, 2026**

**PRIMM VALLEY RESORT & CASINO**

**31900 S Las Vegas Blvd, Primm, NV 89019**

MAIL ENTRIES WITH FEES TO: JACK BRADSHAW, 320 Maple Avenue, Torrance, CA 90503.

MAKE CHECKS payable to JACK BRADSHAW FAX (323) 727-2949; website: www.jbradshaw.com.

ENTRIES must be received by the Superintendent not later than **NOON, Wednesday, Mar 4, 2026 PST**

FIRST ENTRY of a dog at each show **\$36.00**, Additional Class **\$30.00**, Bred by **\$25.00**,

Jr Show Free. Poodle Friday # 1 Show Parade **\$14.00**. Poodle Friday Stud or Brood **\$22.00**

First Entry \$36.00

Each Additional Entry of the Same Dog \$30.00

Bred by \$25.00

Junior Showmanship FREE

ENTRY MUST BE SIGNED at the bottom by the owner or owner's duly authorized agent, otherwise entry cannot be accepted. I ENCLOSE \$\_\_\_\_\_ for entry fees.

BREED		VARIETY 1		SEX	
DOG 2 3 SHOW CLASS			CLASS 3 DIVISION Weight, color, etc.		
ADDITIONAL CLASSES	OBEDIENCE CLASS (Jump Height)	RALLY CLASS (Jump Height)	JR. SHOWMANSHIP CLASS		
NAME OF (See Back) JUNIOR HANDLER (if any)				JR. HANDLER NUMBER	
FULL NAME OF DOG					
<input type="checkbox"/> AKC® NO. <input type="checkbox"/> PAL NO. <input type="checkbox"/> FOREIGN REG NO & COUNTRY			Enter number here DATE OF BIRTH		
			PLACE OF BIRTH (list country) Do not print the above in the catalog.		
BREEDER					
SIRE					
DAM					
<div style="border: 1px solid black; padding: 5px;">                 ACTUAL OWNER(S) _____  <div style="text-align: center; font-size: small;">4 (Please Print)</div>                 OWNER'S ADDRESS _____                  CITY _____ STATE _____ ZIP _____             </div>					
NAME OF OWNER'S AGENT (IF ANY) AT THE SHOW _____					

I CERTIFY that I am the actual owner of the dog, or that I am the duly authorized agent of the actual owner whose name I have entered above. In consideration of the acceptance of this entry, I (we) agree to abide by the rules and regulations of the American Kennel Club in effect at the time of this event, and by any additional rules and regulations appearing in the premium list for this event, and further agree to be bound by the "Agreement" printed on the reverse side of this entry form. I (we) certify and represent that the dog entered is not a hazard to persons or other dogs. This entry is submitted for acceptance on the foregoing representation and Agreement. I (we) agree to conduct myself (ourselves) in accordance with all such Rules and Regulations (including all provisions applying to discipline) and to abide by any decisions made in accord with them.

**Signature** of owner or his agent duly authorized to make this entry: \_\_\_\_\_

Daytime

Telephone

Email

Owner/Handler Eligible? Yes ☐

No ☐

Emergency Contact \_\_\_\_\_ Phone \_\_\_\_\_

### **AGREEMENT**

I (we) agree that the club holding this event has the right to refuse this entry for cause which the club shall deem sufficient. In consideration of the acceptance of this entry and of the holding of this event and of the opportunity to have the dog judged and to win prizes, ribbons, or trophies, I (we) agree to hold the AKC, the event-giving club, their members, directors, governors, officers, agents, superintendents or event secretary and the owner and/or lessor of the premises and any provider of services that are necessary to hold this event and any employees or volunteers of the aforementioned parties, and any AKC approved judge, judging at this event, harmless from any claim for loss or injury which may be alleged to have been caused directly or indirectly to any person or thing by the act of this dog while in or about the event premises or grounds or near any entrance thereto, and I (we) personally assume all responsibility and liability for any such claim; and I (we) further agree to hold the aforementioned parties harmless from any claim for loss, injury or damage to this dog.

Additionally, I (we) hereby assume the sole responsibility for and agree to indemnify, defend and save the aforementioned parties harmless from any and all loss and expense (including legal fees) by reason of the liability imposed by law upon any of the aforementioned parties for damage because of bodily injuries, including death at any time resulting therefrom, sustained by any person or persons, including myself (ourselves), or on account of damage to property, arising out of or in consequence of my (our) participation in this event, however such, injuries, death or property damage may be caused, and whether or not the same may have been caused or may be alleged to have been caused by the negligence of the aforementioned parties or any of their employees, agents, or any other persons.

**I (WE) AGREE THAT ANY CAUSE OF ACTION, CONTROVERSY OR CLAIM ARISING OUT OF OR RELATED TO THE ENTRY, EXHIBITION OR ATTENDANCE AT THE EVENT BETWEEN THE AKC AND THE EVENT-GIVING CLUB (UNLESS OTHERWISE STATED IN ITS PREMIUM LIST) AND MYSELF (OURSELVES) OR AS TO THE CONSTRUCTION, INTERPRETATION AND EFFECT OF THIS AGREEMENT SHALL BE SETTLED BY ARBITRATION PURSUANT TO THE APPLICABLE RULES OF THE AMERICAN ARBITRATION ASSOCIATION. HOWEVER, PRIOR TO ARBITRATION ALL APPLICABLE AKC BYLAWS, RULES, REGULATIONS AND PROCEDURES MUST FIRST BE FOLLOWED AS SET FORTH IN THE AKC CHARTER AND BYLAWS, RULES, REGULATIONS, PUBLISHED POLICIES AND GUIDELINES. 1/1/19**



Please visit

<https://www.instagram.com/jackbradshawdogshows/>

for new information, updates, weather conditions, exhibitor information, etc."



Please like our page at

<https://www.facebook.com/JackBradshawDogShows>

for new information, updates, weather conditions, exhibitor information, etc."

OFFICIAL AMERICAN KENNEL CLUB ENTRY FORM

☐ **Silver State Kennel Club, Saturday, March 21, 2026**

☐ **Silver State Kennel Club, Sunday, March 22, 2026**

**PRIMM VALLEY RESORT & CASINO**

**31900 S Las Vegas Blvd, Primm, NV 89019**

MAIL ENTRIES WITH FEES TO: JACK BRADSHAW, 320 Maple Avenue, Torrance, CA 90503.

MAKE CHECKS payable to JACK BRADSHAW FAX (323) 727-2949; website: www.jbradshaw.com.

ENTRIES must be received by the Superintendent not later than **NOON, Wednesday, Mar 4, 2026 PST**

FIRST ENTRY of a dog at each show **\$36.00**, Additional Class **\$30.00**, Bred by **\$25.00**,

Jr Show Free. Poodle Friday # 1 Show Parade **\$14.00**. Poodle Friday Stud or Brood **\$22.00**

First Entry \$36.00

Each Additional Entry of the Same Dog \$30.00

Bred by \$25.00

Junior Showmanship FREE

ENTRY MUST BE SIGNED at the bottom by the owner or owner's duly authorized agent, otherwise entry cannot be accepted. I ENCLOSE \$\_\_\_\_\_ for entry fees.

BREED		VARIETY 1		SEX	
DOG 2 3 SHOW CLASS			CLASS 3 DIVISION Weight, color, etc.		
ADDITIONAL CLASSES	OBEDIENCE CLASS (Jump Height)	RALLY CLASS (Jump Height)	JR. SHOWMANSHIP CLASS		
NAME OF (See Back) JUNIOR HANDLER (if any)				JR. HANDLER NUMBER	
FULL NAME OF DOG					
<input type="checkbox"/> AKC® NO. <input type="checkbox"/> PAL NO. <input type="checkbox"/> FOREIGN REG NO & COUNTRY			Enter number here DATE OF BIRTH		
			PLACE OF BIRTH (list country) Do not print the above in the catalog.		
BREEDER					
SIRE					
DAM					
<div style="border: 1px solid black; padding: 5px;">                 ACTUAL OWNER(S) _____  <div style="text-align: center; font-size: small;">4 (Please Print)</div>                 OWNER'S ADDRESS _____                  CITY _____ STATE _____ ZIP _____             </div>					
NAME OF OWNER'S AGENT (IF ANY) AT THE SHOW _____					

I CERTIFY that I am the actual owner of the dog, or that I am the duly authorized agent of the actual owner whose name I have entered above. In consideration of the acceptance of this entry, I (we) agree to abide by the rules and regulations of the American Kennel Club in effect at the time of this event, and by any additional rules and regulations appearing in the premium list for this event, and further agree to be bound by the "Agreement" printed on the reverse side of this entry form. I (we) certify and represent that the dog entered is not a hazard to persons or other dogs. This entry is submitted for acceptance on the foregoing representation and Agreement. I (we) agree to conduct myself (ourselves) in accordance with all such Rules and Regulations (including all provisions applying to discipline) and to abide by any decisions made in accord with them.

**Signature** of owner or his agent duly authorized to make this entry: \_\_\_\_\_

Daytime

Telephone

Email

Owner/Handler Eligible? Yes ☐

No ☐

Emergency Contact \_\_\_\_\_ Phone \_\_\_\_\_

AKC Rules, Regulations, Policies and Guidelines are available on the American Kennel Club Web site, [www.akc.org](http://www.akc.org)

### **AGREEMENT**

I (we) agree that the club holding this event has the right to refuse this entry for cause which the club shall deem sufficient. In consideration of the acceptance of this entry and of the holding of this event and of the opportunity to have the dog judged and to win prizes, ribbons, or trophies, I (we) agree to hold the AKC, the event-giving club, their members, directors, governors, officers, agents, superintendents or event secretary and the owner and/or lessor of the premises and any provider of services that are necessary to hold this event and any employees or volunteers of the aforementioned parties, and any AKC approved judge, judging at this event, harmless from any claim for loss or injury which may be alleged to have been caused directly or indirectly to any person or thing by the act of this dog while in or about the event premises or grounds or near any entrance thereto, and I (we) personally assume all responsibility and liability for any such claim; and I (we) further agree to hold the aforementioned parties harmless from any claim for loss, injury or damage to this dog.

Additionally, I (we) hereby assume the sole responsibility for and agree to indemnify, defend and save the aforementioned parties harmless from any and all loss and expense (including legal fees) by reason of the liability imposed by law upon any of the aforementioned parties for damage because of bodily injuries, including death at any time resulting therefrom, sustained by any person or persons, including myself (ourselves), or on account of damage to property, arising out of or in consequence of my (our) participation in this event, however such, injuries, death or property damage may be caused, and whether or not the same may have been caused or may be alleged to have been caused by the negligence of the aforementioned parties or any of their employees, agents, or any other persons.

**I (WE) AGREE THAT ANY CAUSE OF ACTION, CONTROVERSY OR CLAIM ARISING OUT OF OR RELATED TO THE ENTRY, EXHIBITION OR ATTENDANCE AT THE EVENT BETWEEN THE AKC AND THE EVENT-GIVING CLUB (UNLESS OTHERWISE STATED IN ITS PREMIUM LIST) AND MYSELF (OURSELVES) OR AS TO THE CONSTRUCTION, INTERPRETATION AND EFFECT OF THIS AGREEMENT SHALL BE SETTLED BY ARBITRATION PURSUANT TO THE APPLICABLE RULES OF THE AMERICAN ARBITRATION ASSOCIATION. HOWEVER, PRIOR TO ARBITRATION ALL APPLICABLE AKC BYLAWS, RULES, REGULATIONS AND PROCEDURES MUST FIRST BE FOLLOWED AS SET FORTH IN THE AKC CHARTER AND BYLAWS, RULES, REGULATIONS, PUBLISHED POLICIES AND GUIDELINES. 1/1/19**



Please visit

<https://www.instagram.com/jackbradshawdogshows/>

for new information, updates, weather conditions, exhibitor information, etc."



Please like our page at

<https://www.facebook.com/JackBradshawDogShows>

for new information, updates, weather conditions, exhibitor information, etc."